

OPERATING TEMP.	-40 ~ +85
-----------------	-----------



### 特征 FEATURES

- 同尺寸下集多个磁珠于一体，适合于更高密度、更高效率的表面贴装。
- 在较宽频率范围内具有优秀的阻抗频率特性，对各种噪声提供优良的抑制。
- 独石设计，将漏磁、邻近回路串扰减至最小。
- 应用于回流焊、波峰焊。

- Combine beads with the same dimension into one, suitable for SMT with higher density and efficiency.
- Super impedance frequency within the relatively wide range of frequency, providing excellent suppression to all kinds of noises.
- Monolithic designing, minimizing disturbance from magnetic shield and circuit nearby.
- Used in reflow or wave soldering.

### 应用 APPLICATIONS

- 应用在 HDTV、计算机 I/O 线、液晶显示器外围总线、打印机、传真机等。

- Applied in HDTV, computer I/O wire, peripheral wire of LCD, printer, facsimile and so on.

### 产品规格型号的表示方法 ORDERING CODE

CBA 321609 - 4 U 310 T

产品代号 Product Code		规格尺寸(L×W×T) (mm) Dimensions		回路数 Circuit Num.		材料 Material Code	阻抗( ) Impedance		包装方式 Packaging Style	
CBA	片式磁珠排 Multilayer Chip Beads Array	321609	3.2×1.6×0.9	实例 Example		U 料	实例 Example		T	卷带盘装 Tape & Reel
				4	4 circuits		310	31	B	散装 Bulk
							601	600		

### 外形尺寸及等效电路 DIMENSIONS & EQUIVALENT CIRCUIT

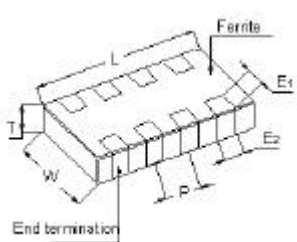

unit : mm

L	W	T
3.2 ± 0.2	1.6 ± 0.2	0.9 ± 0.1
E <sub>1</sub>	E <sub>2</sub>	P
0.35 ± 0.2	0.3 ± 0.2	0.8 ± 0.1

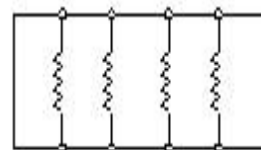

### 电性能参数 ELECTRICAL CHARACTERISTICS

Part No.	Impedance ( ) At 100MHz	DCR ( ) Max	I <sub>r</sub> (mA) Max
CBA321609—4U—310	31	0.10	500
CBA321609—4U—600	60	0.15	500
CBA321609—4U—800	80	0.20	500
CBA321609—4U—121	120	0.35	500
CBA321609—4U—151	150	0.35	500
CBA321609—4U—221	220	0.45	300
CBA321609—4U—301	300	0.50	250

Part No.	Impedance ( ) At 100MHz	DCR ( ) Max	Ir (mA) Max
CBA321609—4U—501	500	0.60	200
CBA321609—4U—601	600	0.70	200
CBA321609—4U—801	800	0.70	100
CBA321609—4U—102	1000	0.80	50
CBA321609—4U—122	1200	0.90	50

特性曲线 CHARACTERISTICS CURVES

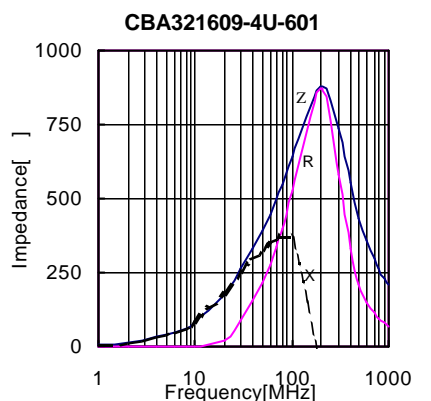
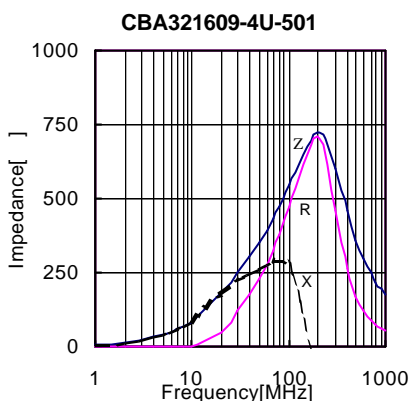
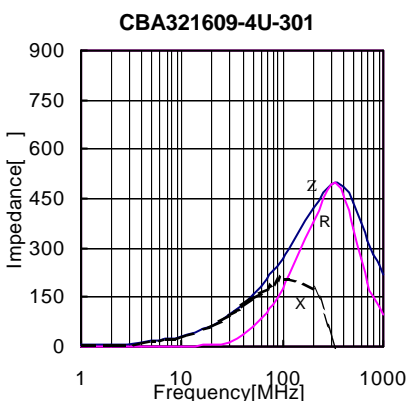
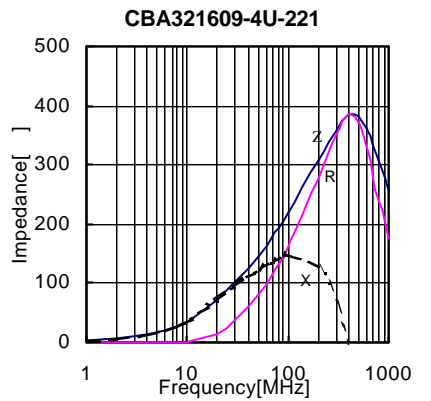
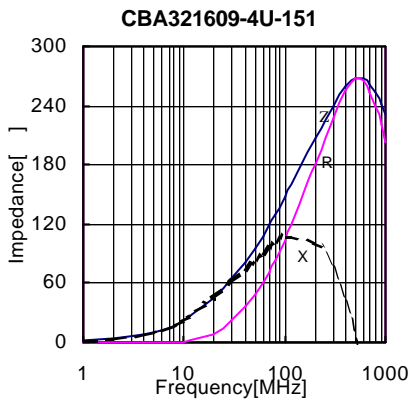
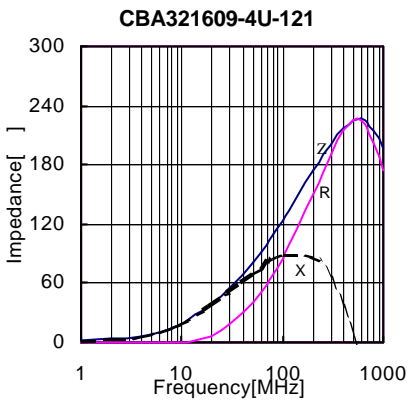
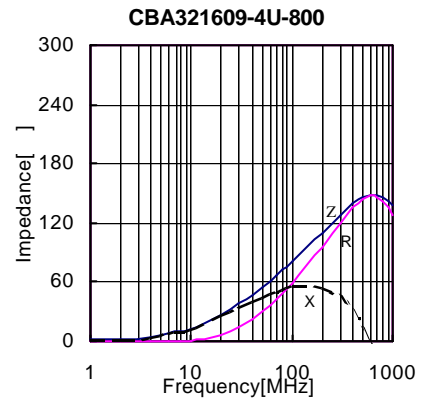
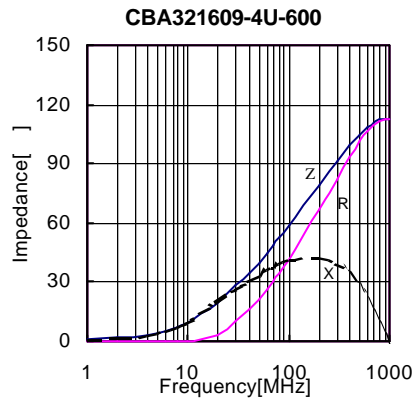
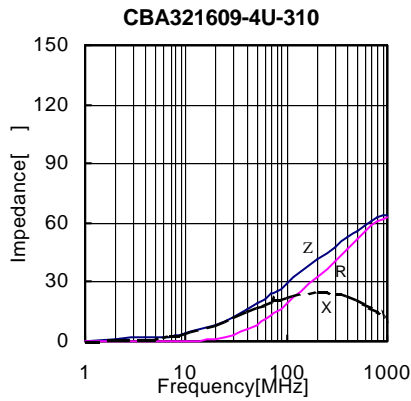

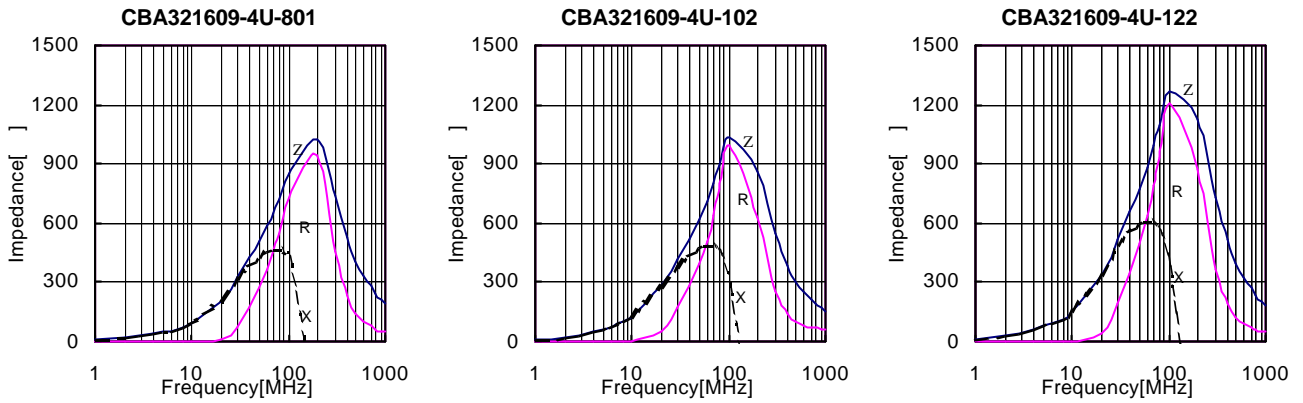

**包装 PACKAGING**

**包装数量 PACKAGING NUMBER**

Pcs/Reel	3000	Pcs/Box	15000	Pcs/Case	180000
----------	------	---------	-------	----------	--------

**塑料胶带 Embossed Carrier**

单位 unit : mm

	A	B	C	N	G
CF-8	178 1/-2.0	22.0 1/-2.0	12.5 1/-1.5	67 1/-2.0	8

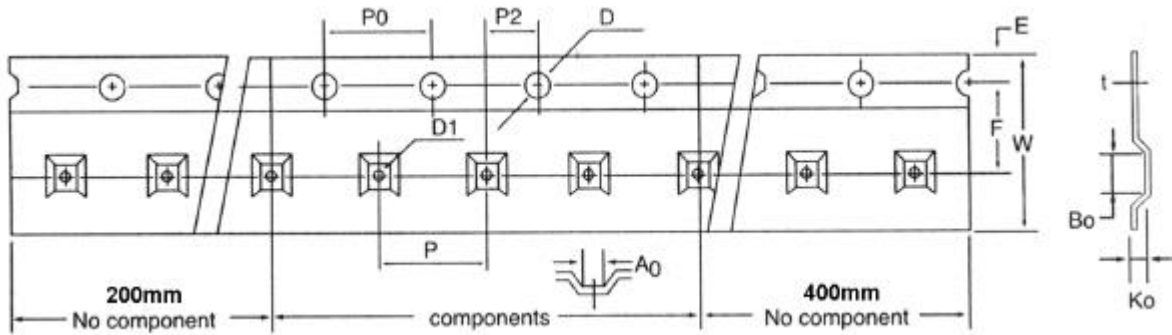
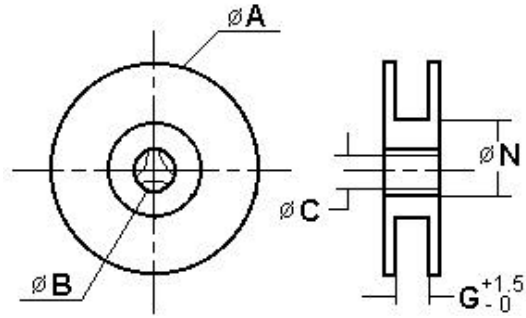

unit : mm

W	P	E	F	D	D1	t
8.1+/-0.2	4.0+/-0.10	1.75+/-0.10	3.50+/-0.10	1.55+/-0.05	1.50 <sup>+0.25</sup> <sub>-0</sub>	0.23+/-0.10
P <sub>0</sub>	P <sub>0</sub> 10	P2	A <sub>0</sub>	B <sub>0</sub>	K <sub>0</sub>	
4.0+/-0.10	40.0+/-0.20	2.0+/-0.05	1.85+/-0.10	3.50+/-0.10	1.10+/-0.10	

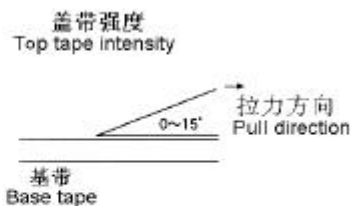
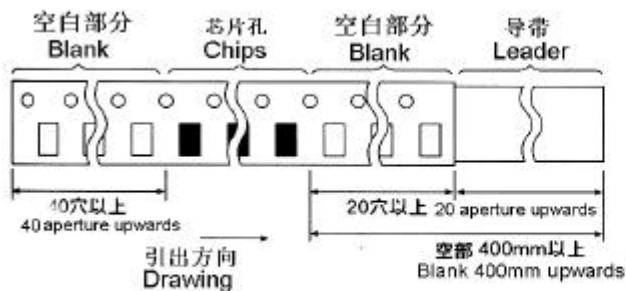

沿箭头方向拉时要求盖带的剥离力为0.1~0.7N.  
Peeling force should be 0.1~0.7N pulling in the direction of arrow.