

料罐秤、各种压式测力场合
Hopper scale, testing situations for compression

TECHNICAL PARAMETER

4Wires:Exc+(红,Red);Exc-(黑,Black);Sig+(绿,Green);Sig-(白,White)

额定载荷 Rated capacities (Emax)	0.1,0.2,0.5,1,2.5,10,20,30,50t	温度补偿范围 Temperature range, compensated	-10°C~+40°C
灵敏度 Sensitivity	2.0 ± 0.05mV/V(0.05~1t); 2.0 ± 0.02mV/V (2~50t)	工作温度范围 Temperature range, operating	-30~+70°C
综合误差 Total error	± 0.5%F.S(0.05~1t); ± 0.3%F.S(2~50t)	安全过载 Maximum safe overload	150%F.S
蠕变(30分钟) Creep error (30min)	± 0.05%F.S	极限过载 Ultimate overload	180%F.S
零点平衡 Zero balance	± 1%F.S	推荐激励电压 Excitation, recommend	10~12V DC
零点温度影响 TCO	± 0.05%F.S/10°C	最大激励电压 Excitation, maximum	15V DC
输出温度影响 TC SPAN	± 0.05%F.S/10°C	防封等级 Protection class	IP68
输入阻抗 Input impedance	400 ± 20Ω	材质 Construction	合金钢 Alloy Steel
输出阻抗 Output impedance	352 ± 3Ω	电缆 Cable	Length:3m(0.05~1t),6m(2~5t),12m(10~50t)
绝缘电阻 Insulation impedance	≥ 5000MΩ		Diameter: φ 5mm

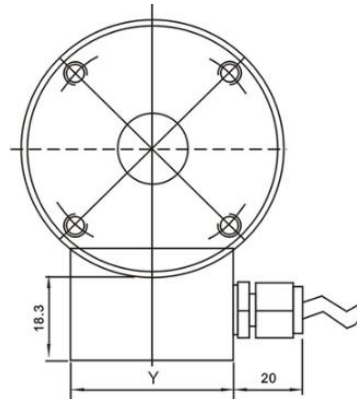

额定载荷(t) Rated Load	A	B	C	D	E	F	G	H	T	X	Y
0.05~1	50	30	42	M5	7	60	34	7	13	20	35
2~5	90	48	70	M10	12	100	55	12.5	25	30	50
10~20	115	60	90	M12	16	160	68	12.5	32	30	50
30~50	155	90	125	M16	20	300	97	15.5	44	30	50

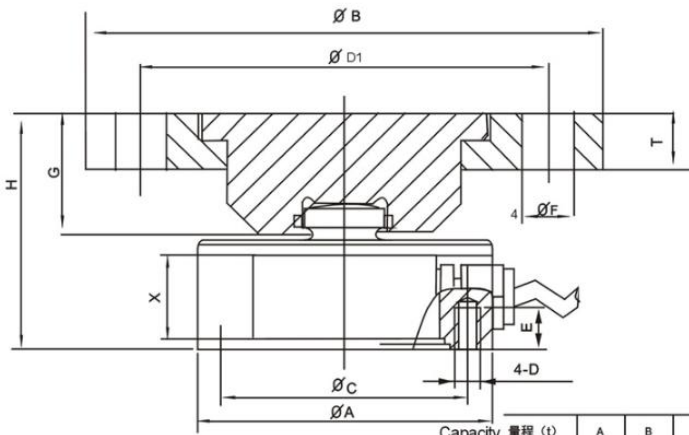

Capacity 量程 (t)	A	B	C	D	D1	E	F	G	H	T	X
0.05~1	50	89	42	M5	70	7	9	21	46	10	20
2~5	90	89	70	M10	70	12	9	21	64	10	30
10~20	115	110	90	M12	90	16	13	27.5	80	15	30
30~50	155	147	125	M16	120	20	17	50	133	22	30