

HT170系列 单相单级电源滤波器

- π 型电路
- 低泄漏电流
- 滤波范围从10KHz到30MHz
- 有效滤波频段100KHz到20MHz
- 适用于抑制尖峰、连续或间歇电磁干扰



型号	额定电流 A	连接方式			外壳	电感量 L mH	电容		电阻 R M Ω
							Cx μ F	Cy nF	
HT170-1-W5-D3	1	W5	--	--	D3	6.5	0.1	2.2	1
HT170-3-W5-D3	3	W5	--	--	D3	2.5	0.1	2.2	1
HT170-6-W5-D3	6	W5	--	--	D3	1.3	0.1	2.2	1
HT170-10-L8-??	10	--	L8	--	B2/B3	1.4	0.22	2.2	1
HT170-16-L8-??	16	--	L8	--	B2/B3	0.8	0.22	2.2	1
HT170-20-??-??	20	--	L8	M4	B2/B3	0.54	0.22	2.2	1
HT170-30-M4-H2	30	--	--	M4	H2	0.8	0.47	4.7	1
HT170-50-M6-E2	50	--	--	M6	E2	0.6	1.0	4.7	0.47
HT170-60-M6-E2	60	--	--	M6	E2	0.4	1.0	4.7	0.47
HT170-80-M8-G2	80	--	--	M8	G2	0.6	2.2	10	0.22
HT170-100-M8-G2	100	--	--	M8	G2	0.3	2.2	10	0.22
HT170-120-M8-G2	120	--	--	M8	G2	0.2	2.2	10	0.22

* 连接方式: W5-引线 (127mm); L8-焊片 (6.3*0.8); M4-M4螺栓; M8-M8螺栓; ??-两种连接方式或外壳供选择

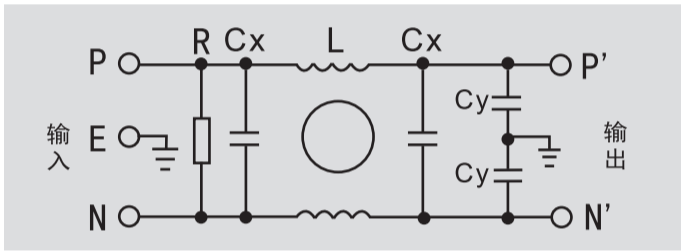

工作频率: 50/60Hz

最高工作电压: 250VAC

耐压测试(三秒钟):

1760VDC (线-线) 2000VAC (线-地)

温度范围: -25 $^{\circ}$ C ~ +85 $^{\circ}$ C

泄漏电流: 1A ~ 60A < 1mA @ 250VAC/50Hz

80A ~ 120A < 2mA @ 250VAC/50Hz

绝缘电阻: > 200M Ω @ 500VDC

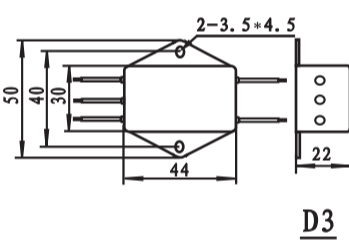

D3

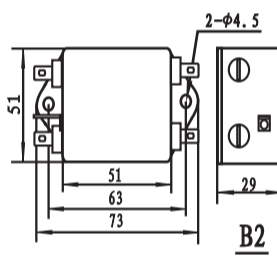

B2

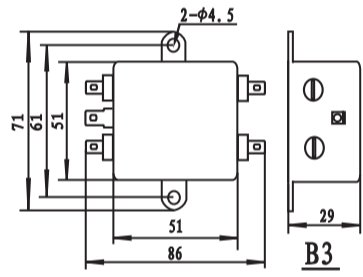

B3

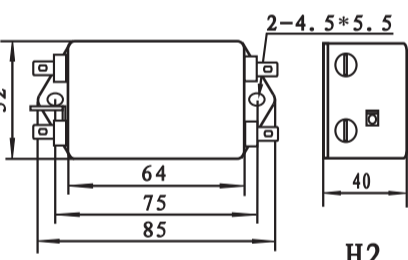

H2

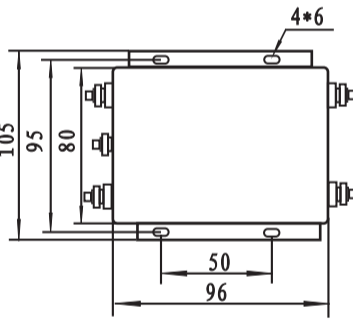

E2

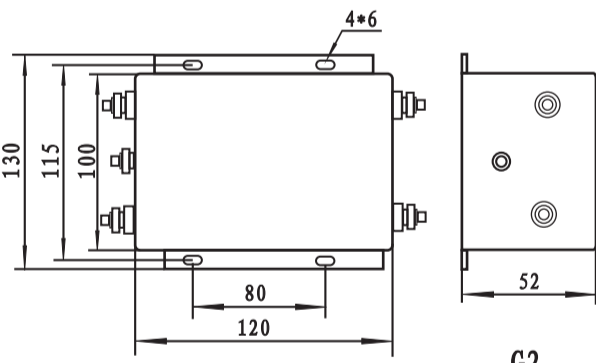

G2

深圳翔迪利电子
 电话: 0755-61362887
 传真: 0755-61362887
 Q Q: 821470184
 www.xldz.2008jy.net

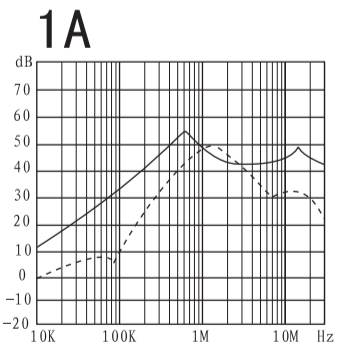

1A

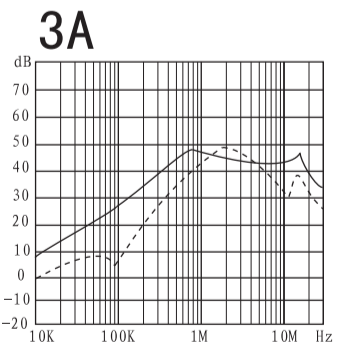

3A

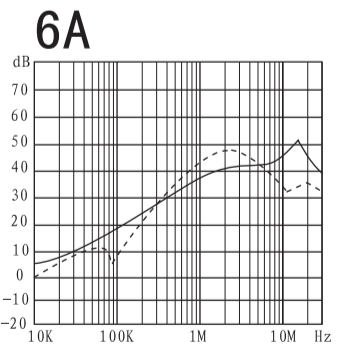

6A

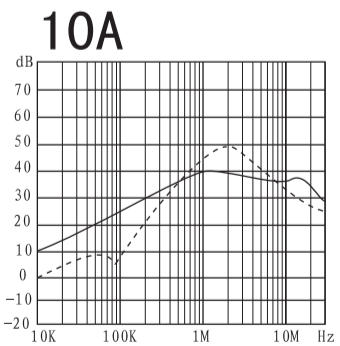

10A

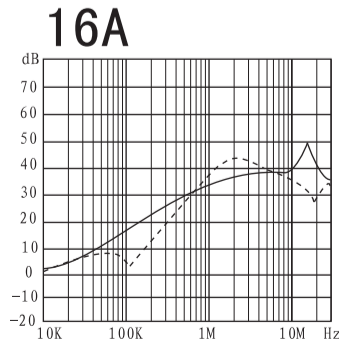

16A

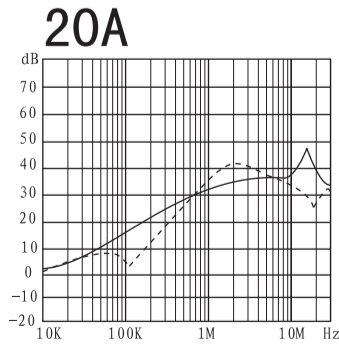

20A

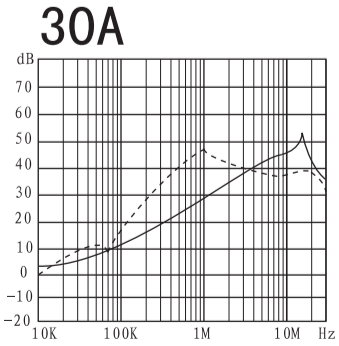

30A

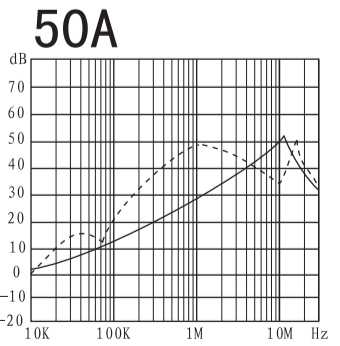

50A

插入损耗图 50 Ω /50 Ω (符合IEC/CISPR N0.17)

共模: ——— 差模: - - - - -