

Recommended P/N 20323-0**E-12, 20323-R**E-12

POS.	PART NO.	A	B	C	D	E	F	REMARK
30P	20323-030E-###	14.5	19.4	16.25	15.3	12.5	15.2	
	20323-R30E-###							Red Phosphorus Free
40P	20323-040E-###	19.5	24.4	21.25	20.3	17.5	20.2	
	20323-R40E-###							Red Phosphorus Free
50P	20323-050E-###	24.5	29.4	26.25	25.3	22.5	25.2	
	20323-R50E-###							Red Phosphorus Free

◆ MARK MEANS NOT AVAILABLE.



WITH CUTOUT DEPTH : 0.05

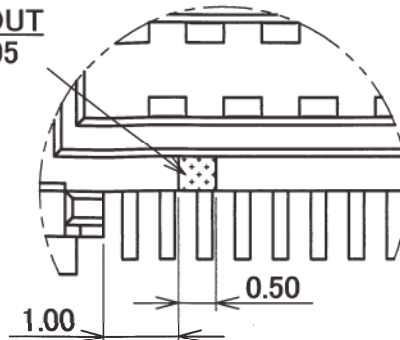

DETAIL H
P/N:20323-R**-###
(Red Phosphorus Free)

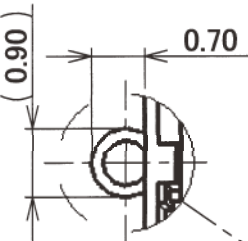
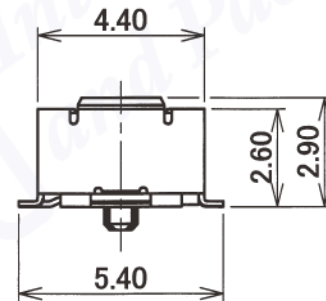
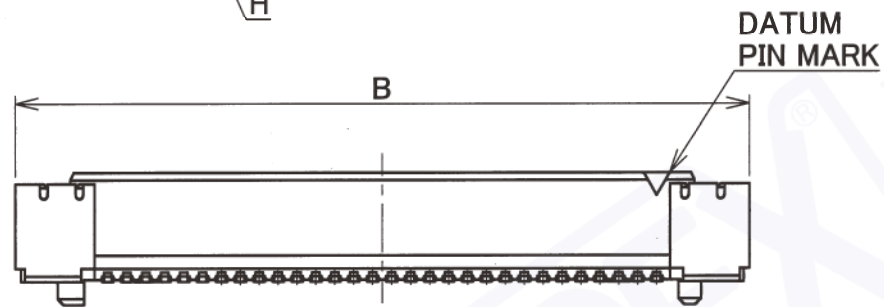
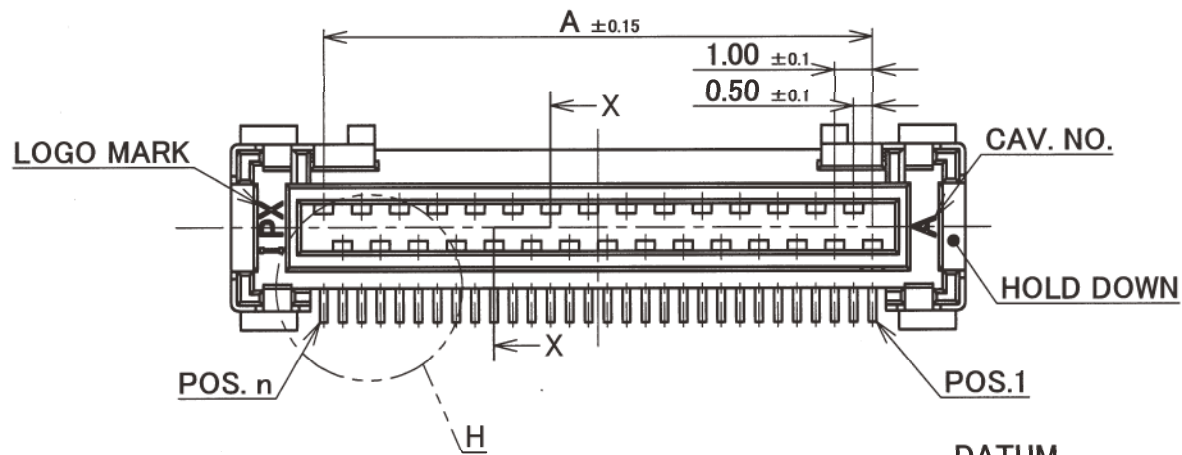

DETAIL (S=10/1)

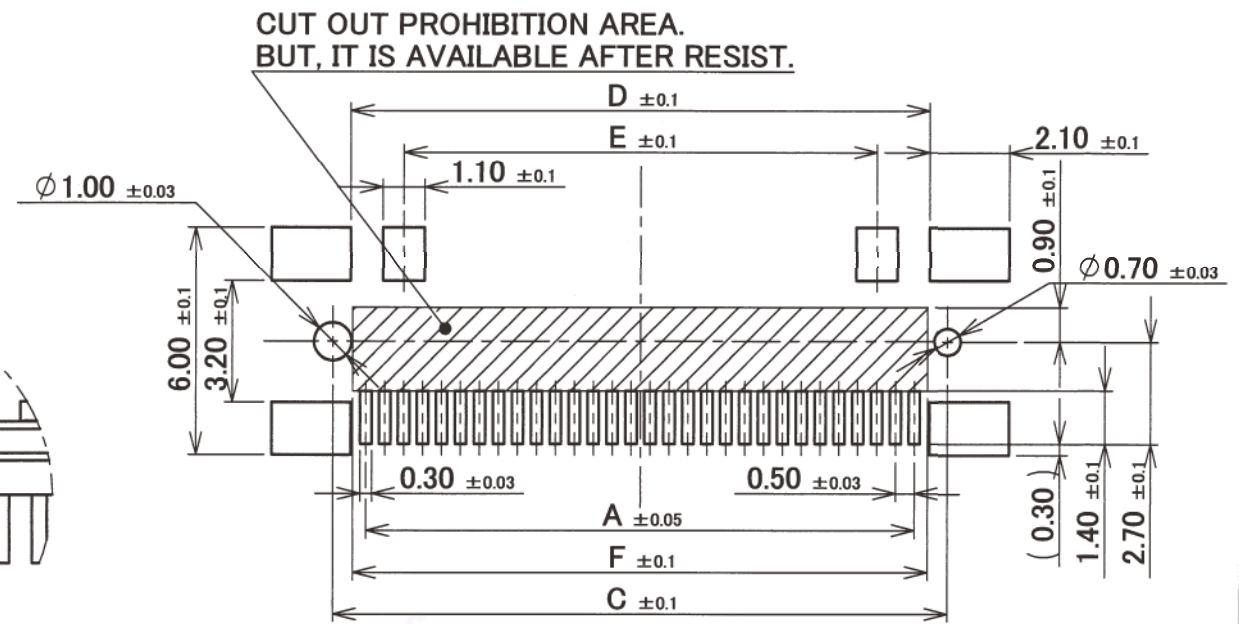
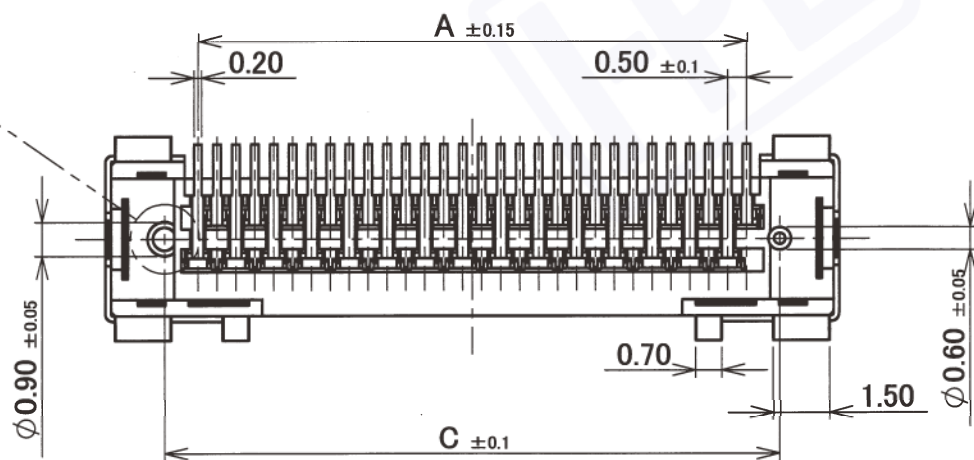

RECOMMENDED PCB LAYOUT
& METAL MASK LAYOUT
METAL MASK THICKNESS : t=0.12mm

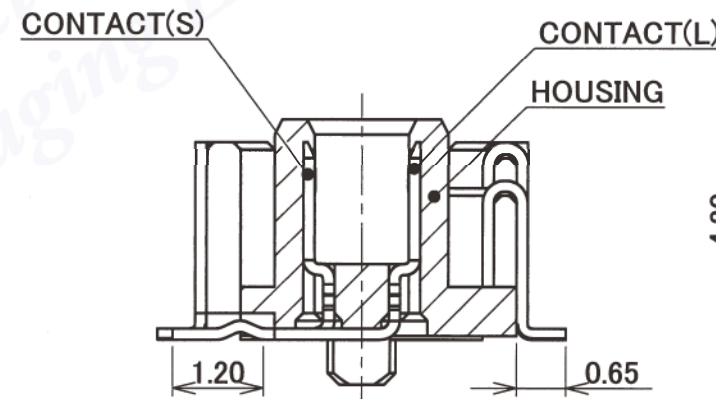

SECT. X-X (S=10/1)

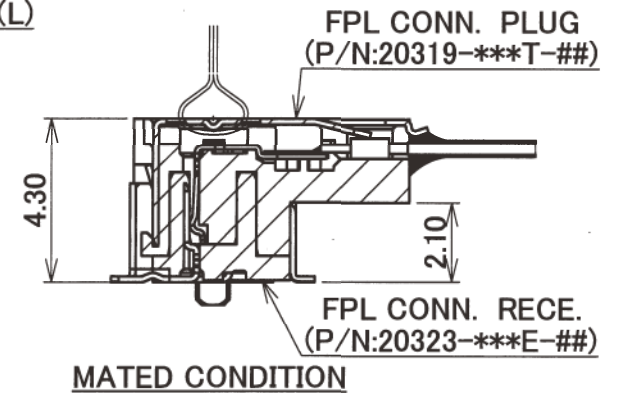

MATED CONDITION

NOTES

- MATERIAL
 - HOUSING : HEAT RESISTING PLASTICS (GLASS REINFORCED) UL94V-0, BEIGE
 - CONTACT : COPPER ALLOY
 - HOLD DOWN : COPPER ALLOY
 - ADHESION TAPE : PI
- Product specification No. : PRS-1198
Instruction manual No. : HIM-06003
- COPLANARITY : 0.1 MAX.
- RoHS Compliant

PATENT PENDING

GENERAL TOLERANCE	
6 MAX.	±0.2
6 OVER MAX. 30	±0.3
30 OVER MAX. 120	±0.5
ANGLE	±2°

I-PEX DAI-ICHI SEIKO CO.,LTD.
I-PEX Business Company

TITLE		SCALE		UNIT		DWG. No.		SHEET		REV.	
FPL CONN. RECE. ASS'Y(FOR#32~#40)		5:1		mm		20323		1/2		17	

SERIES No. R5 CUSTOMER COPY



SCALE 5:1 UNIT mm

DWG. No. 20323

SHEET 1/2

REV. 17

Recommended P/N 20323-0**E-12, 20323-R**E-12

Part No.	G
20323-*30E-##W	13.00
20323-*40E-##W	18.00

20323-***E-##*

HOUSING MATERIAL TYPE No.
 20323-0**-## ...LCP
 20323-R**-## ...LCP (Red Phosphorus Free)

ADHESION TAPE No.
 20323-***E-## ...WITHOUT MARK : ADHESION TAPE LENGTH = 6.0±1.0
 20323-***E-##W ...W MARK : ADHESION TAPE LENGTH = 18.0±1.0
 20323-***E-##N ...N MARK : NOTHING ADHESION TAPE

POS. NO.

BOSS No.
 20323-***E-#1 ...WITH BOSS
 20323-***E-#2 ...WITHOUT BOSS

DATE CODE No.
 20323-***E-## ...WITHOUT DATE CODE
 20323-***ED## ...WITH DATE CODE

CONTACT PLATING TYPE No.
 20323-***E-1# ...Au 0.2 μm MIN.(MATING SIDE)
 20323-***E-4# ...Au 0.3 μm MIN.(MATING SIDE)

	PART NO.	BOSS	DATE CODE	C/T FINISH(MATING SIDE)	C/T FINISH(TAIL SIDE)	H/D FINISH
①	20323-***E-11	WITH	WITHOUT	Au (0.2 μm MIN.)	Au (0.03~0.07 μm.)	Sn-Cu
	20323-***E-12	WITHOUT				
	20323-***ED11	WITH	WITH			
	20323-***ED12	WITHOUT				
②	20323-***E-41	WITH	WITHOUT	Au (0.3 μm MIN.)	Au (0.03~0.07 μm.)	Sn-Cu
	20323-***E-42	WITHOUT				
	20323-***ED41	WITH	WITH			
	20323-***ED42	WITHOUT				

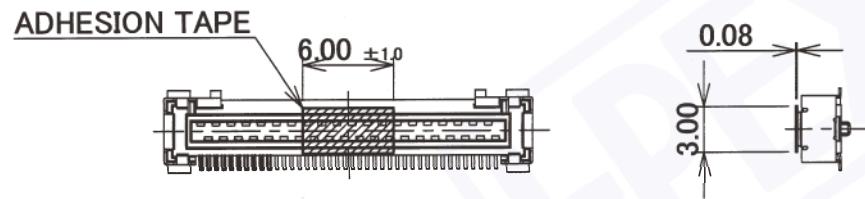

DIMENSIONS OF ADHESION TAPE (P/N:20323-***E-##)

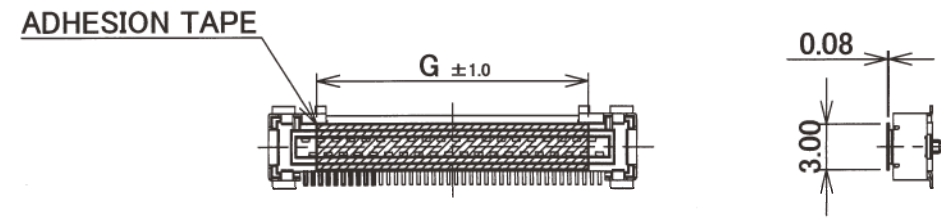

DIMENSIONS OF ADHESION TAPE (P/N:20323-***E-##W)

GENERAL TOLERANCE	
6 MAX.	±0.2
6 OVER MAX. 30	±0.3
30 OVER MAX. 120	±0.5
ANGLE	±2°

PATENT PENDING

I-PEX DAI-ICHI SEIKO CO.,LTD.
 I-PEX Business Company

TITLE		FPL CONN. RECE. ASS'Y(FOR#32~#40)	
SCALE	UNIT	DWG. No.	SHEET
5:1	mm	20323	2/2
CUSTOMER COPY	PROJECTION	SERIES No.	REV.
		R5	17