

REV.	ECON. NO.	APPD.
A		Peter

NOTES:

1. MATERIAL & FINISH:

HOUSING: LCP, UL94V-0, BLACK;

TERMIANL: COPPER ALLOY / Au ON CONTACT AREA AND 1u" MIN

MIN Au ON SOLDERING AREA OVER Ni 50u" MIN ;

SHELL: COPPER ALLOY / Sn OVER Ni .

2. THE WARPAGE OF PRODUCT SHOULD BE NOT EXCEED 0.10mm.

3. PART NO.: LV021XX-2XX

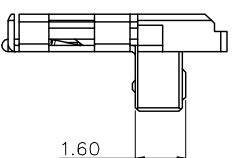
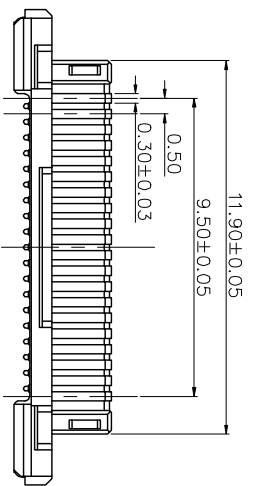

PIN: _____
 20=20P
 13=13P

TYPE:
 2=插接片
 3=压接片

PLATING:
 1=接触区域3~5u" Au
 2=接触区域10u" Au

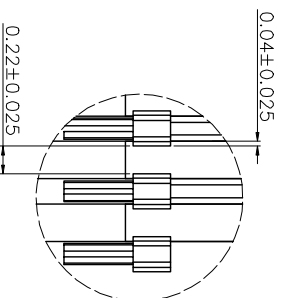

DETAIL: A-A

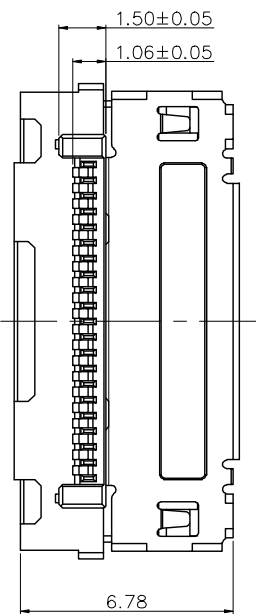

X±	X.±	UNITS	mm	NAME/(INTENDED USE)	客户图	Lowinsh 江苏联特域电子科技有限公司
.X± 0.20	.X± 2'	MAT'L	N/A	PART NO.:(INTENDED USE)	LV021XX-2X3	TITLE: LVC PLUG CONN. 0.5PH 4.0H
.XX± 0.10	.XX±1'	FINISH	N/A	APPD:	Peter Chen 03/20/2013	DWG NO.: C-LV021-001
.XXX±	.XXX±			CHKD:	Vincent Chen 03/20/2013	SCALE SHEET REV. N/A
THE GENERATED DRAWING IS BY ACAD, PROE OR IDEAS.DO NOT CHANGE BY HAND.		Q'TY	N/A	DR:	Joy Wu 03/20/2013	SCALE SHEET REV. N/A