

# SF series

Washable miniature toggle switches •  
insulated threaded bushing



## DISTINCTIVE FEATURES

- Process sealed
- Front and rear sealing
- Optional ESD protection



## ENVIRONMENTAL SPECIFICATIONS

- Operating temperature : -20 °C to +85 °C (-4 °F to +185 °F)
- Storage temperature : -40 °C to +85 °C (-40 °F to +185 °F)
- Moisture : The insulating materials employed and the complete seal permit the switches to withstand a 56 days moisture test (IEC 68-2-3).
- Solderability : The switches are tested at 235 °C (455 °F) according to IEC 68-2-20 after accelerated aging.



## ELECTRICAL SPECIFICATIONS

- Max. current/voltage rating with resistive load :
  - silver contacts (A) : 4 A 30 VDC
  - gold plated brass contacts (CD) : 0.4 VA 20 VAC or DC
  - gold plated silver contacts (AD) : 4 A 30 VDC (300 mA 30 VDC for gold plating)
- Initial contact resistance : 10 mΩ max.
- Insulation resistance : 1,000 MΩ min.
- Dielectric strength : 1,000 Vrms 50 Hz min.
- Electrical life at full load :

Contacts	Number of cycles	
	2 positions	3 positions
A	40,000	40,000
CD	100,000	50,000
AD	40,000	40,000

The company reserves the right to change specifications without notice.



# SF series

Washable miniature toggle switches • insulated threaded bushing



## GENERAL SPECIFICATIONS

- Mechanical strength : Terminals are strengthened by a bracket or a ground plate ensuring the rigidity of the switch on the board. Actuator strength is 10 N max.
- Iron soldering : 300 °C (572 °F) 5 sec. max.
- Max. torque : 0.25 Nm (.184 Ft.lb)
- Max. panel thickness : 2.5 mm (.098) with 2 nuts, 4 mm (.157) with 1 nut



## MATERIALS

- Case and cover : UL94-VO, polyamide, glass filled or PES
- Actuator : brass, nickel plated
- Contacts
  - CD : brass, gold plated
  - A : silver
  - AD : silver, gold plated
- Terminal seal : epoxy



## TERMINALS

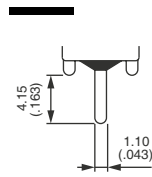

Straight PC

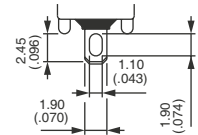

Solder lug / quickconnect



## ELECTRICAL FUNCTIONS

KEYWAY



## PANEL CUT-OUT

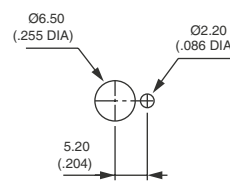

# SF series

Washable miniature toggle switches • insulated threaded bushing

## BUILD YOUR PART NUMBER

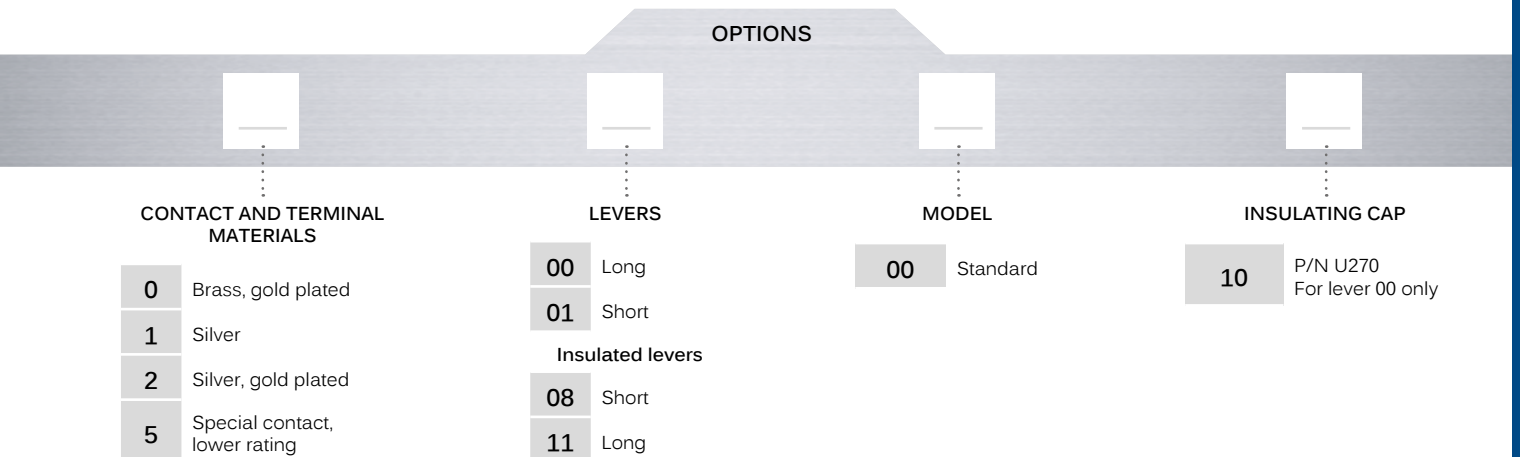
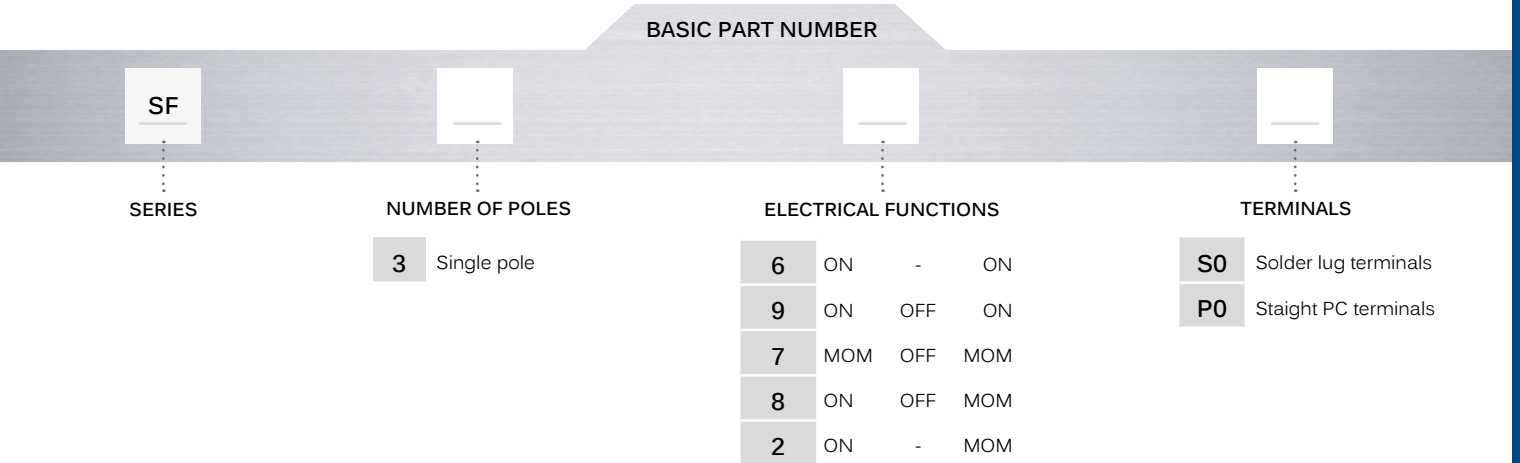

## ABOUT THIS SERIES

On the following pages, you will find successively basic part numbers of switches and options in the same order as in above chart.

 **Notice** : please note that not all combinations of above numbers are available. Refer to the following pages for further information.

 **Mounting accessories** : 2 hex nuts 8 mm (.314) across flats, 1 locking ring and 1 lockwasher. Standard and special hardware available is presented in the "Accessories" section of website.

# SF series

Washable miniature toggle switches • insulated threaded bushing

## SOLDER LUGS TERMINALS



	III 2-3	II	I 1-2
SF36S0	ON	-	ON
SF39S0	ON	OFF	ON
SF37S0	MOM	OFF	MOM
SF38S0	ON	OFF	MOM
SF32S0	ON	-	MOM

Shown with standard lever 00

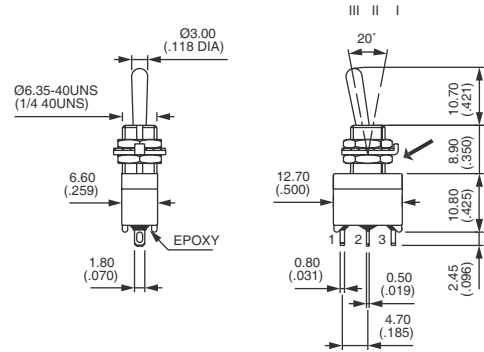

## STRAIGHT PC TERMINALS



	III 2-3	II	I 1-2
SF36P0	ON	-	ON
SF39P0	ON	OFF	ON
SF37P0	MOM	OFF	MOM
SF38P0	ON	OFF	MOM
SF32P0	ON	-	MOM

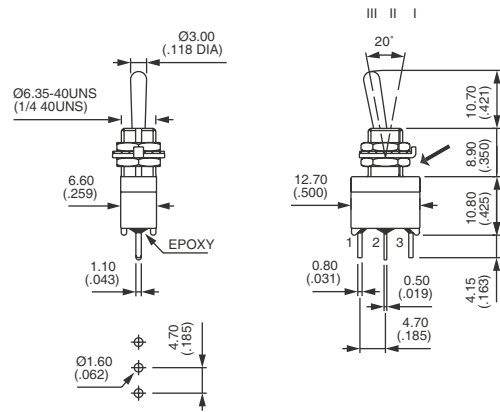

## CONTACT & TERMINAL MATERIALS



- 0 Brass, gold plated (standard)
- 1 Silver
- 2 Silver, gold plated
- 5 Special contact, lower rating, minimum quantity : consult factory.

## LEVERS

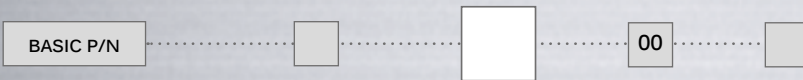

## INSULATED LEVERS

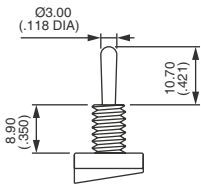

00 Standard

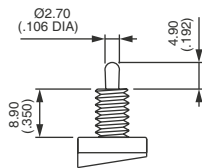

01 Short

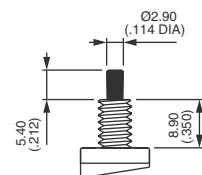

08 Short

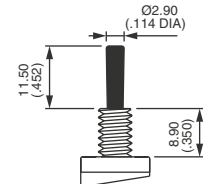

11 Long

Protected against electrostatic discharges (ESD) up to 12 KV. Black color.

# SF series

Washable miniature toggle switches •  
insulated threaded bushing

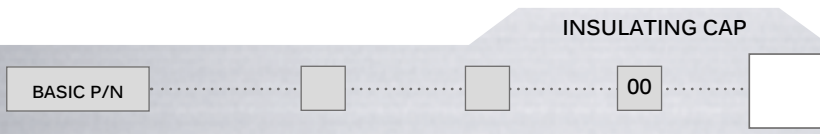

**Blank** Without caps  
**10** P/N U270 - For lever 00

For cap colors, replace "0" with number :

- 1 Blue
- 1/4 Dark blue
- 2 Black
- 3 Green
- 4 Grey
- 5 Yellow
- 6 Red
- 7/1 White
- 9 Orange

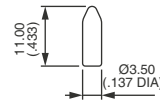

10

To order cap separately, use its part number (U270).