

ESDB18HP

Transient Voltage Suppressors

for ESD Protection

Features

- Bi-direction high reliability
- Low leakage current

PINNING

PIN	DESCRIPTION
1	Anode
2	Anode

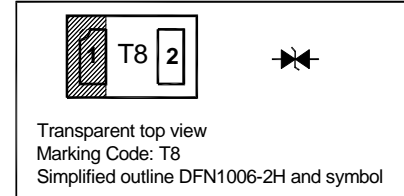

Absolute Maximum Ratings ($T_a = 25^\circ\text{C}$)

Parameter	Symbol	Value	Unit
Peak Pulse Current ($t_p = 8/20 \mu\text{s}$)	I_{PP}	1.6	A
IEC61000-4-2 (ESD) Air Contact	V_{ESD}	± 30 ± 30	KV
Peak Pulse Power ($t_p = 8/20 \mu\text{s}$)	P_{PK}	40	W
Operation Temperature Range	T_j	- 55 to + 150	$^\circ\text{C}$
Storage Temperature Range	T_{stg}	- 55 to + 150	$^\circ\text{C}$

Characteristics at $T_a = 25^\circ\text{C}$

Parameter	Symbol	Min.	Typ.	Max.	Unit
Reverse Stand-Off Voltage	V_{RWM}	-	-	16	V
Reverse Breakdown Voltage at $I_R = 1 \text{ mA}$	$V_{(BR)R}$	17.1	-	18.9	V
Reverse Current at $V_{RWM} = 16 \text{ V}$	I_R	-	-	100	nA
Clamping Voltage at $I_{PP} = 1 \text{ A}$, $t_p = 8/20 \mu\text{s}$	V_C	-	-	25	V
Junction Capacitance at $V_R = 0 \text{ V}$, $f = 1 \text{ MHz}$	C_j	-	21	-	pF

TOP DYNAMIC

ESDB18HP

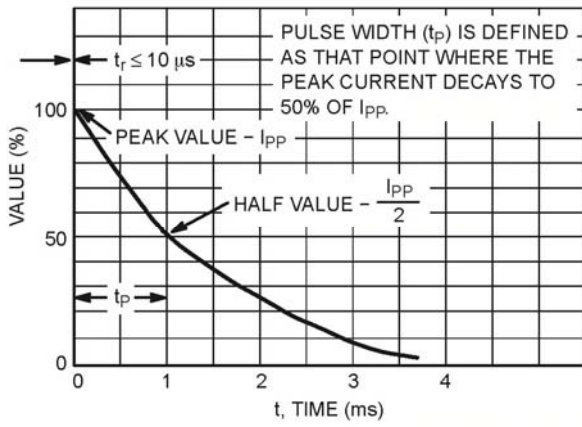

Pulse Waveform

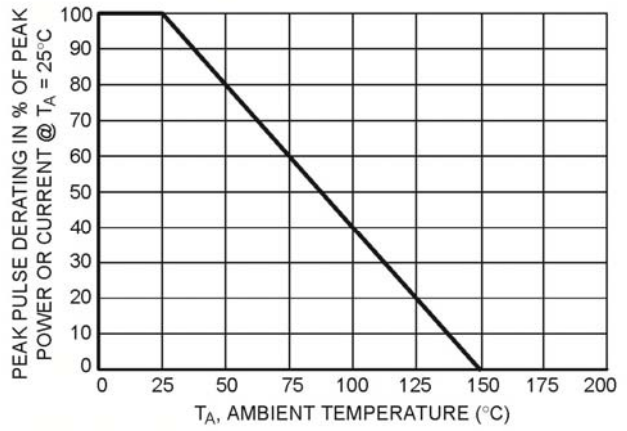

Pulse Derating Curve

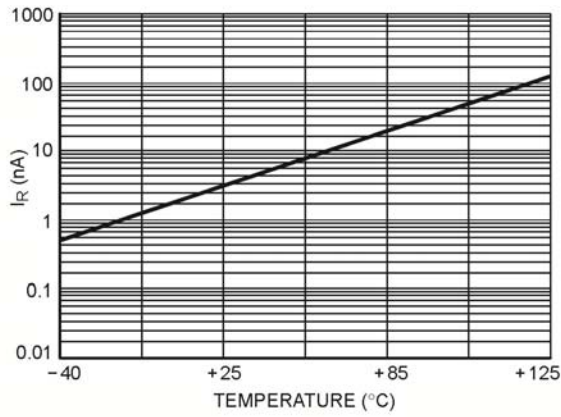

Typical Leakage Current versus Temperature

TOP DYNAMIC

ESDB18HP

PACKAGE OUTLINE

Plastic surface mounted package

DFN1006-2H

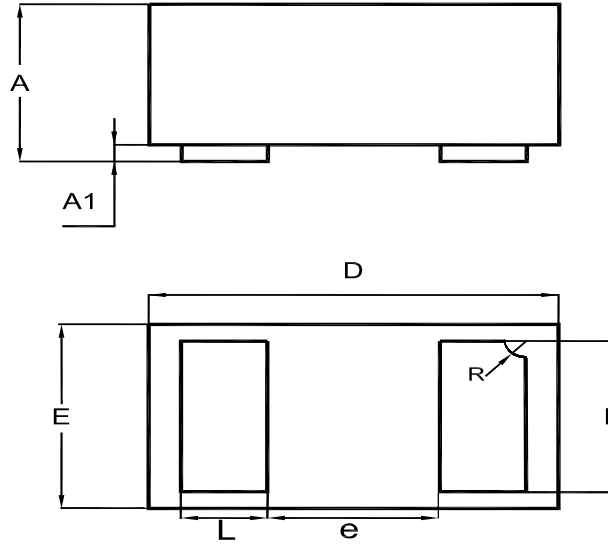

UNIT	A	A1	b	D	E	e	L	R
mm	0.51 0.46	0.05 0	0.55 0.45	1.05 0.95	0.65 0.55	0.4	0.3 0.2	0.15 0.05

Recommended Soldering Footprint

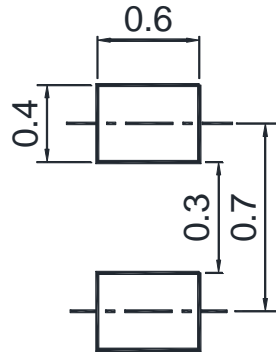

Packing information

Package	Tape Width (mm)	Pitch		Reel Size		Per Reel Packing Quantity
		mm	inch	mm	inch	
DFN1006-2H	8	4 ± 0.1	0.157 ± 0.004	178	7	5,000

TOP DYNAMIC