

ESDBL0550BP

Transient Voltage Suppressors

for ESD Protection

Features

- Protects one data or power line
- Low leakage current
- Bi-direction high reliability
- Low junction capacitance

PINNING

PIN	DESCRIPTION
1	Anode
2	Anode

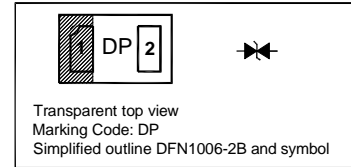

Absolute Maximum Ratings ($T_a = 25^\circ\text{C}$)

Parameter	Symbol	Value	Unit
Peak Pulse Power ($t_p = 8/20 \mu\text{s}$)	P_{PK}	50	W
ESD discharge (IEC61000-4-2) Air Contact	V_{ESD}	± 15 ± 8	KV
Operation Temperature Range	T_j	- 55 to + 150	$^\circ\text{C}$
Storage Temperature Range	T_{stg}	- 55 to + 150	$^\circ\text{C}$

Characteristics at $T_a = 25^\circ\text{C}$

Parameter	Symbol	Min.	Max.	Unit
Reverse Working Voltage	V_{RWM}	-	5	V
Reverse Breakdown Voltage at $I_R = 1 \text{ mA}$	$V_{(BR)R}$	5.8	7.8	V
Reverse Current at $V_R = 5 \text{ V}$	I_R	-	1	μA
Clamping Voltage at $I_{PP} = 5 \text{ A}$, $t_p = 8/20 \mu\text{s}$	V_C	-	17	V
Junction Capacitance at $V_R = 0 \text{ V}$, $f = 1 \text{ MHz}$	C_j	-	25	pF

TOP DYNAMIC

Dated: 11/07/2017 Rev:01

POWER DERATION CURVE

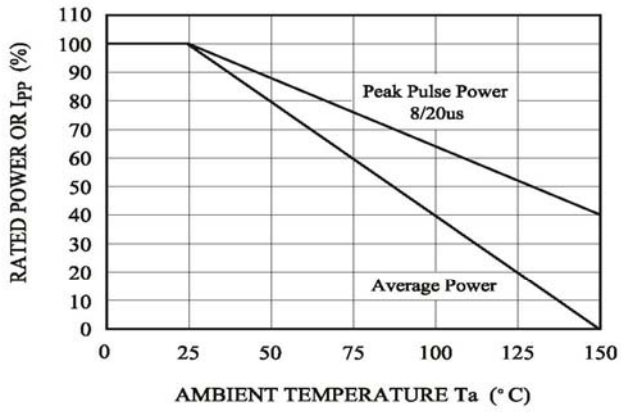

$V_Z - I_Z$

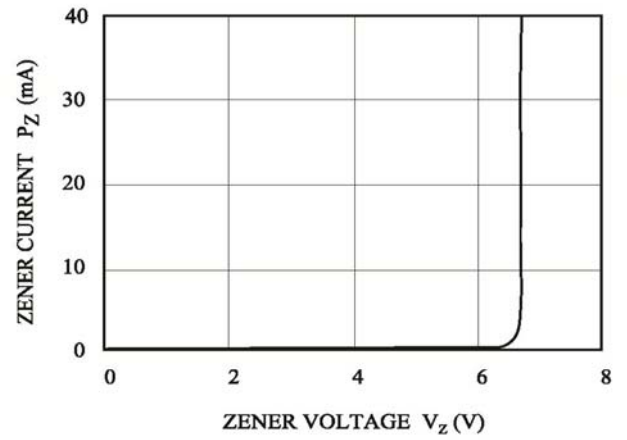

$P_D - T_a$

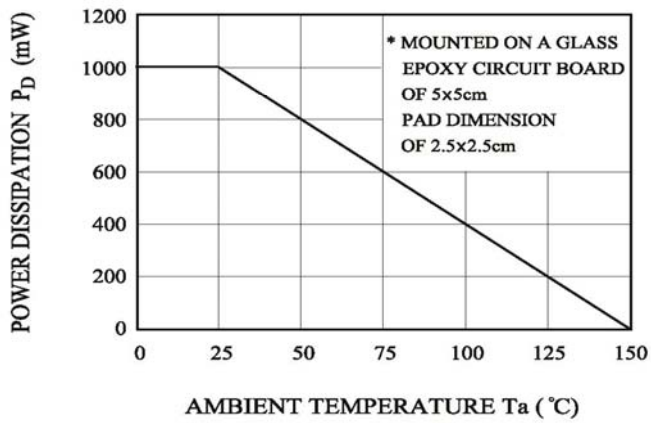

PULSE WAVEFORM

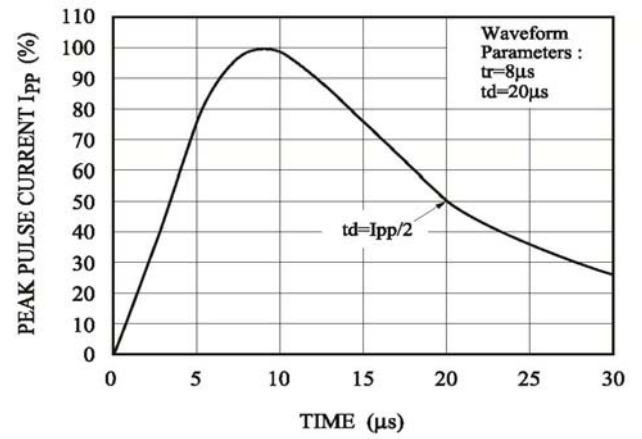

ESDBL0550BP

PACKAGE OUTLINE

Plastic surface mounted package; 2 leads

DFN1006-2B

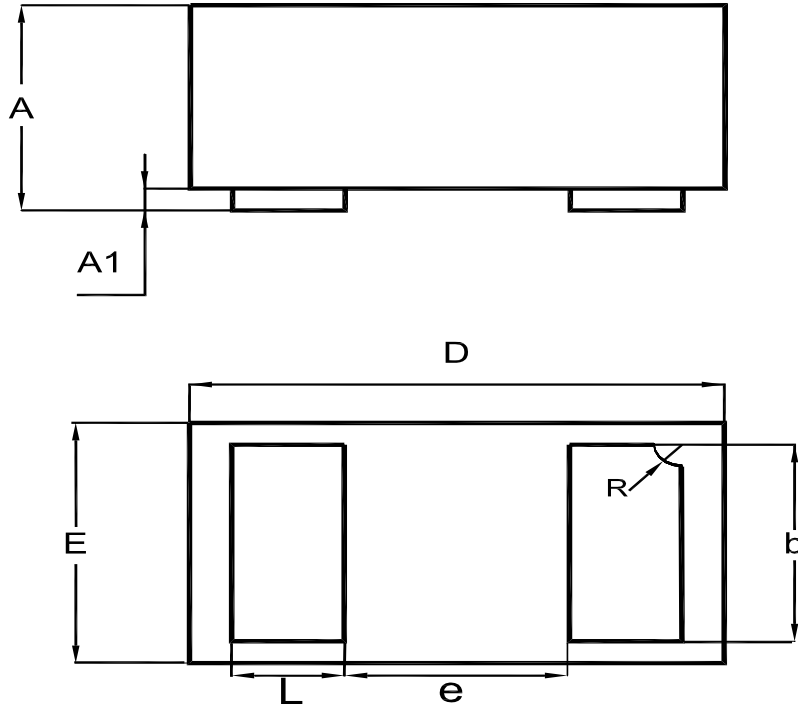

UNIT	A	A1	b	D	E	e	L	R
mm	0.40	0.05	0.55	1.05	0.65	0.4	0.3	0.15
	0.36	0	0.45	0.95	0.55		0.2	0.05

Recommended Soldering Footprint

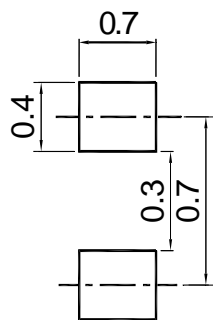

Packing information

Package	Tape Width (mm)	Pitch		Reel Size		Per Reel Packing Quantity
		mm	inch	mm	inch	
DFN1006-2B	8	4 ± 0.1	0.157 ± 0.004	178	7	5,000

TOP DYNAMIC

Dated: 11/07/2017 Rev:01