

# ESDBL24DP

## Transient Voltage Suppressors

for ESD Protection

### Features

- Low leakage current
- Low capacitance
- Bi-direction high reliability

### PINNING

PIN	DESCRIPTION
1	Anode
2	Anode

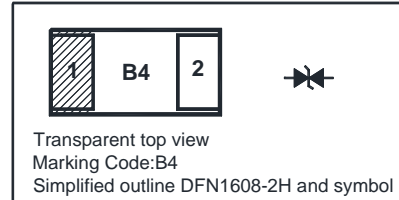

### Absolute Maximum Ratings ( $T_a = 25^\circ\text{C}$ )

Parameter	Symbol	Value	Unit
Peak Pulse Current (tp = 8/20 $\mu\text{s}$ )	$I_{PP}$	1	A
IEC61000-4-2 (ESD) Air Contact	$V_{ESD}$	$\pm 20$ $\pm 18$	KV
Operation Temperature Range	$T_j$	- 55 to + 150	$^\circ\text{C}$
Storage Temperature Range	$T_{stg}$	- 65 to + 150	$^\circ\text{C}$

### Characteristics at $T_a = 25^\circ\text{C}$

Parameter	Symbol	Min.	Max.	Unit
Reverse Working Voltage	$V_{RWM}$	- 24	24	V
Reverse Breakdown Voltage at $I_R = 1 \text{ mA}$	$V_{(BR)R}$	24.3	-	V
Reverse Current at $V_{RWM} = 24 \text{ V}$	$I_R$	-	50	nA
Clamping Voltage at $I_{PP} = 1 \text{ A}$ , tp = 8/20 $\mu\text{s}$	$V_C$	-	45	V
Junction Capacitance at $V_R = 0 \text{ V}$ , f = 1 MHz	$C_j$	-	3.5	pF

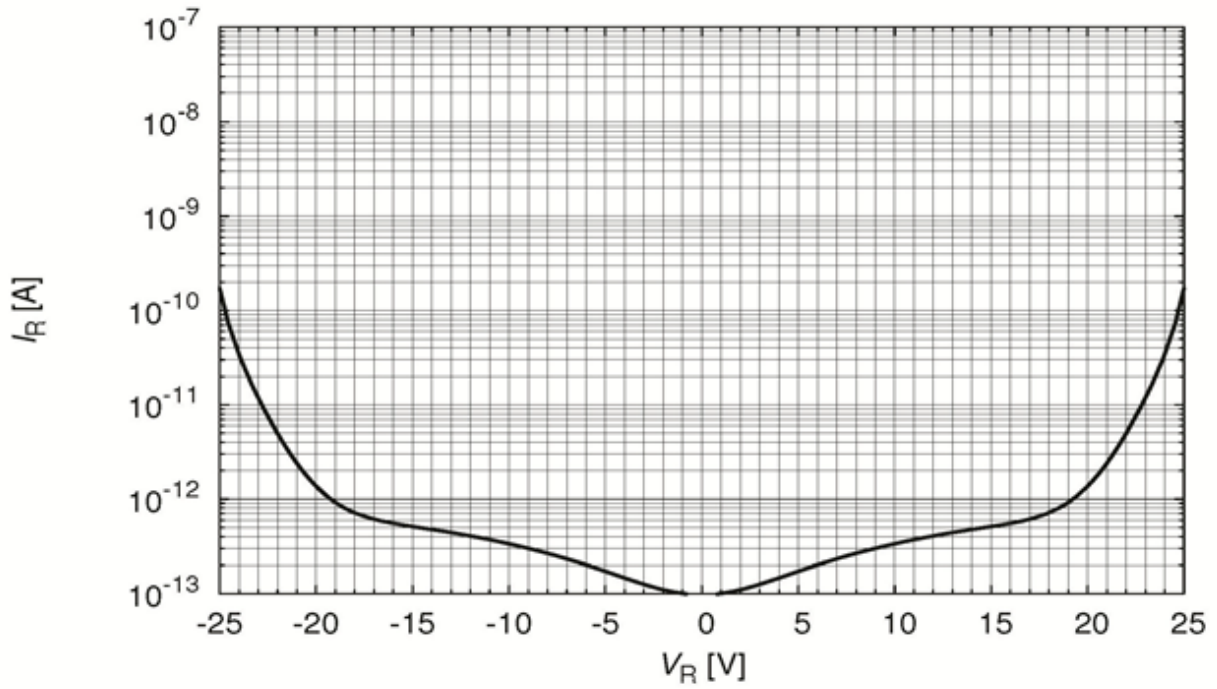

Reverse current:  $I_R = f(V_R)$

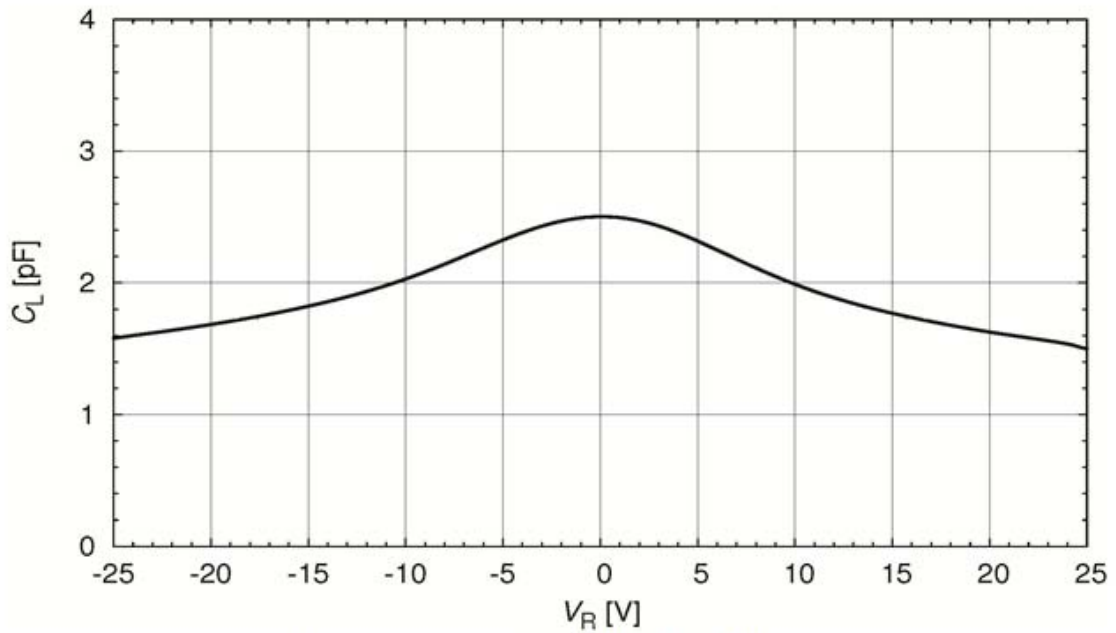

Line capacitance:  $C_L = f(V_R)$ ,  $f = 1\text{MHz}$

# ESDBL24DP

## PACKAGE OUTLINE

Plastic surface mounted package; 2 leads

DFN1608-2H

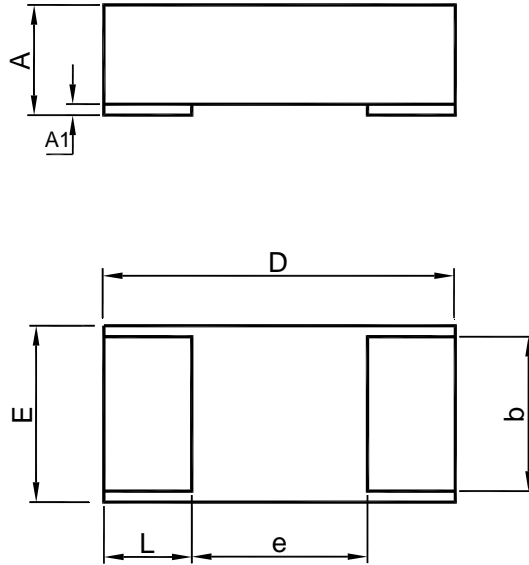

UNIT	A	A1	b	D	E	e	L
mm	0.55	0.05	0.75	1.65	0.85	0.85	0.45
	0.45	0	0.65	1.55	0.75	0.75	0.35

## Recommended Soldering Footprint

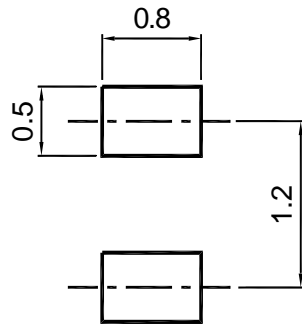

## Packing information

Package	Tape Width (mm)	Pitch		Reel Size		Per Reel Packing Quantity
		mm	inch	mm	inch	
DFN1608-2H	8	4 ± 0.1	0.157 ± 0.004	178	7	4,000

**TOP DYNAMIC**

Dated: 05/06/2017 Rev: 01