

R12F5MW-HAF

Surface Mount General Purpose Silicon Rectifiers Reverse Voltage 1050 V Forward Current - 1.2 A

Features

- Halogen and Antimony Free(HAF), RoHS compliant

PINNING

PIN	DESCRIPTION
1	Cathode
2	Anode

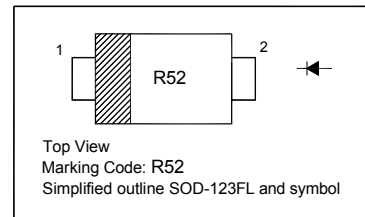

Maximum Ratings and Electrical characteristics

Ratings at 25°C ambient temperature unless otherwise specified.

Single phase half-wave 60 Hz, resistive or inductive load, for capacitive load current derate by 20 %.

Parameter	Symbols	Value	Units
Maximum Repetitive Peak Reverse Voltage	V_{RRM}	1050	V
Maximum RMS voltage	V_{RMS}	735	V
Maximum DC Blocking Voltage	V_{DC}	1050	V
Maximum Average Forward Rectified Current at $T_a = 65^\circ\text{C}$	$I_{F(AV)}$	1.2	A
Peak Forward Surge Current Single Half Sine Wave Superimposed on Rated Load (JEDEC Method)	I_{FSM}	50 150	A
Maximum Instantaneous Forward Voltage at 1.2 A	V_F	1	V
Maximum DC Reverse Current at Rated DC Blocking Voltage	I_R	1 100	μA
Typical Junction Capacitance ¹⁾	C_j	30	pF
Typical Thermal Resistance ²⁾	$R_{\theta JA}$	180	$^\circ\text{C/W}$
Operating and Storage Temperature Range	T_j, T_{stg}	- 55 to + 150	$^\circ\text{C}$

¹⁾ Measured at 1 MHz and applied reverse voltage of 4 V D.C

²⁾ Thermal resistance from junction to ambient at 0.375" (9.5 mm) lead length, P.C.B. mounted

TOP DYNAMIC

R12F5MW-HAF

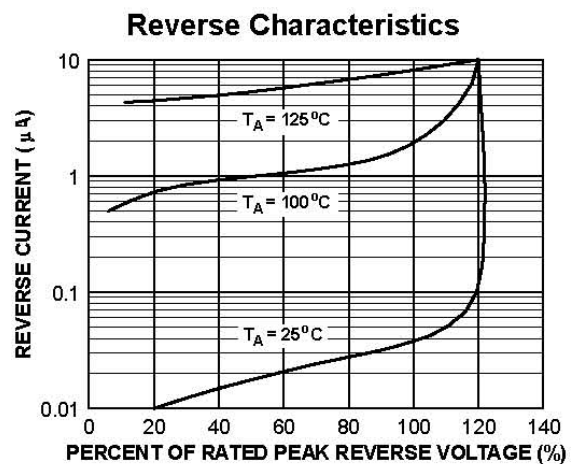
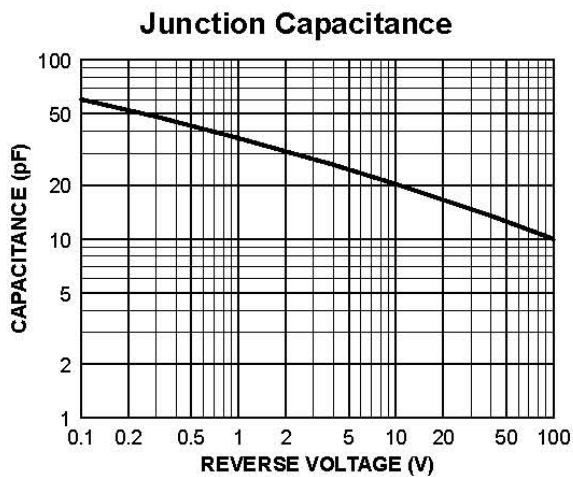
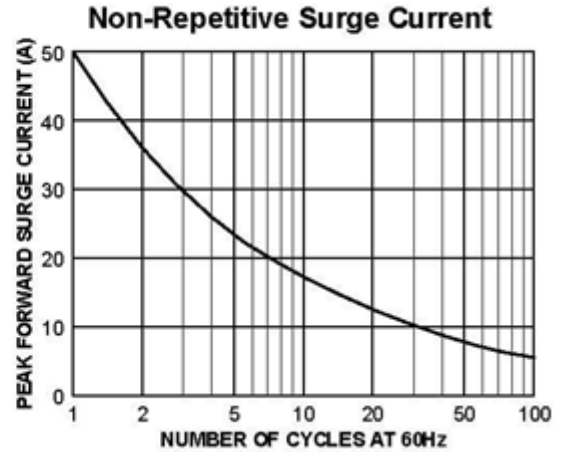
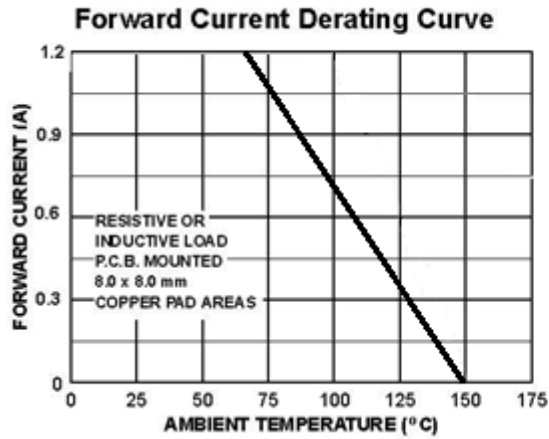

TOP DYNAMIC

R12F5MW-HAF

PACKAGE OUTLINE

Plastic surface mounted package; 2 leads

SOD-123FL

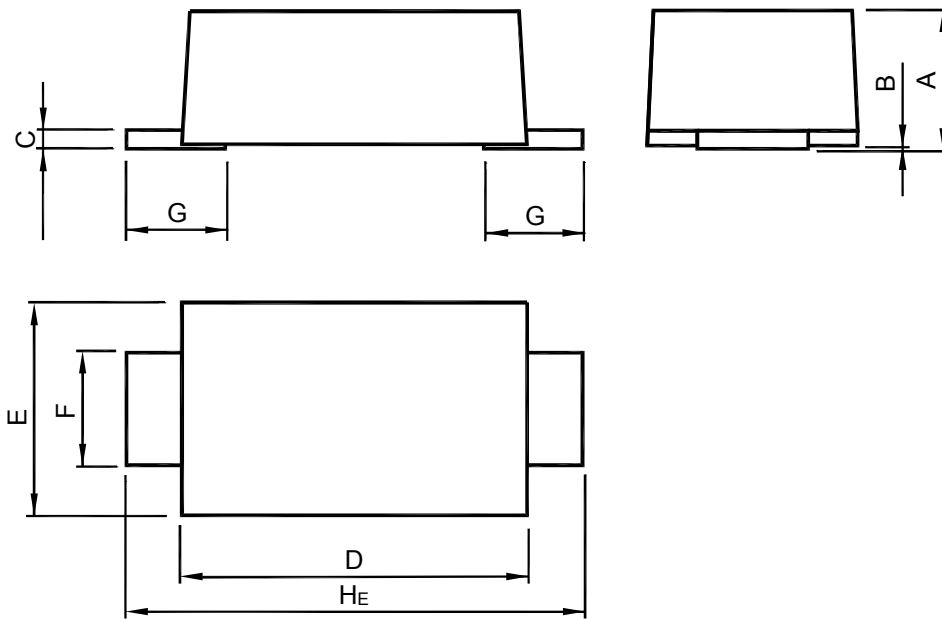

UNIT	A	B	C	D	E	F	G	H _E
mm	1.08	0.1	0.2	2.9	1.9	1.1	0.9	3.9
	0.88	0	0.1	2.6	1.7	0.8	0.7	3.5

Recommended Soldering Footprint

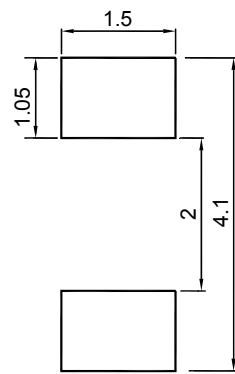

SOD-123FL

TOP DYNAMIC