

RECOMMENDED PANEL CUTOUT
EMPFOHLENER FRONTPLATTEN-AUSSCHNITT

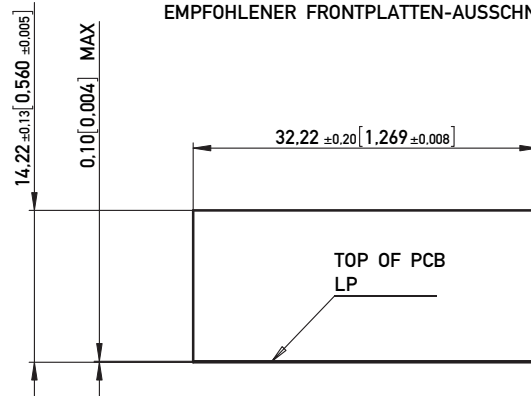

RECOMMENDED PCB LAYOUT (COMPONENT SIDE VIEW)
EMPFOHLENES LEITERPLATTEN-LAYOUT (BESTUECKUNGSSEITE)
TOL. ±0.05 [0.002] UNLESS NOTED

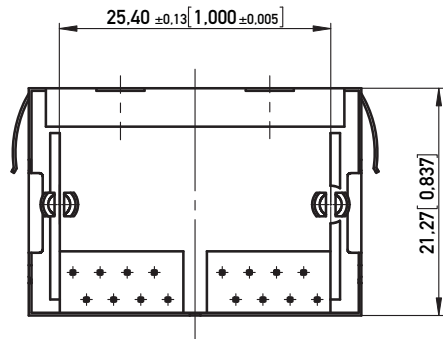
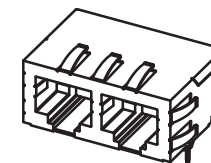
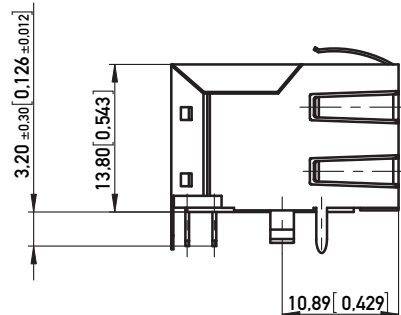
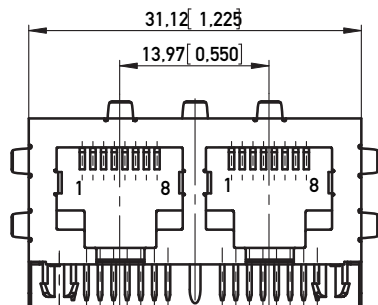
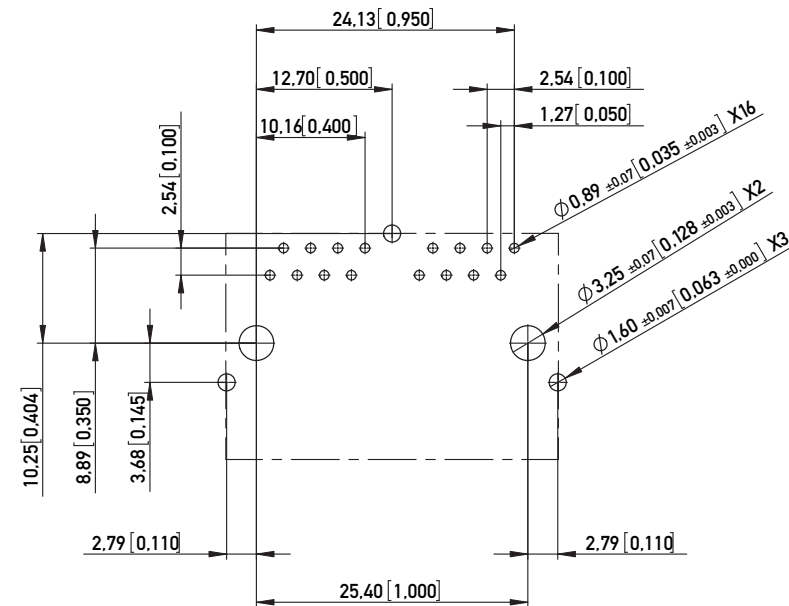

1:1

- NOTE 1: PANEL GROUND FLANGES TOP. SIDES (GF5)
NOTE 2: C-UL APPROVED E145613 AND MEETS FCC REQUIREMENTS
NOTE 3: RoHS COMPLIANT

Technical specifications

| Materials & Finish | Standard applic. | Value |
|---------------------------------|----------------------|--------------------------------|
| Insulation body | Standard description | PBT 30% |
| Contact material | Standard description | C5210 (acc. JIS) |
| Contact finish, mating zone | Thickness of plating | 30 µin Au over 50 µin Ni |
| Contact finish termination zone | Thickness of plating | 80 µin matte Sn over 50 µin Ni |
| Shell/shield material | Standard description | C2680 (acc. JIS) |
| Shell/shield plating | Thickness of plating | 50 µin Ni |

Assembly process

| | |
|---------------------------|---------------|
| Packaging | Tray |
| Solder temperature | 235°C at 3-5s |
| Suitable assembly process | wave |

Approvals

| | | |
|--------------------|---------|-----|
| UL insulation body | UL 94 | V0 |
| UL File No. | E145613 | |
| RoHS compliant | | Yes |

Test Data Standard applic. Value

| Mechanical properties | Standard applic. | Value |
|--|------------------|------------|
| Insertion/withdrawal force | IEC 603-7 | max. 20 N |
| Mechanical operations | IEC 512-5, 9a | min. 1.000 |
| Effectiveness of connector coupling device | IEC 512-8, 15f | 50 N |

Electrical properties

Creepage / clearance distances

| | | |
|----------------------|-----------|-------------|
| a) Contact - contact | IEC 807-3 | 0.52 mm |
| b) Contact - shell | IEC 807-3 | min. 1.0 mm |

Voltage proof (Dielectric Withstand Voltage)

| | | |
|------------------------------|---------------|--------------------|
| a) Contact - contact | IEC 512-2, 4a | min. 1.000 V AC/DC |
| b) Contact - shell/testpanel | IEC 512-2, 4a | min. 1.500 V AC/DC |
| Current carrying capacity | IEC 512-3, 5b | 1.5 A @ 25° C |
| Contact resistance | IEC 512-2, 2a | max. 30 mOhm |
| Insulation resistance | IEC 512-2, 3a | min. 500 MOhm |

Environmental properties

| | |
|-----------------------|-----------|
| Operation temperature | 0 - 70° C |
|-----------------------|-----------|

| PART NO. IDENT. NR. | TRANSMISSION REQUIREMENT ÜBERTRAGUNGSANFORDERUNG | | |
|--|--|--------------|--|
| 133208 | CATEGORY 3/4 | | |
| Information: | Tolerances ISO 2768-m DIN 7167 | Scale 2:1 | Designation MOD JACK - MJR 8P8C, 1X2 |
| All rights reserved. Only for Information. To insure that this is the latest version of this drawing, please contact one of the ERNI companies before using. | Subject to modification without prior notice. Drawing will not be updated. | www.ERNI.com | 133922 |
| C | 04.07.2007 | | 1 (1/1) |
| Index | Date | Class | A3 |
| | | MJ | |