

## Model 1419

dc to 18.0 GHz

## Medium Power, Ruggedized SMA Connectors

10 Watts



**POWER RATING:** 10 watts **average (mounted horizontally)** @ 25°C ambient temperature, derated linearly to 0 watts @ 125°C. 1 kilowatt **peak** (5 µsec pulse width; 0.5% duty cycle).

**TEMPERATURE RANGE:** -55°C to +125°C

**TEST DATA:** Swept data plots of SWR from 50 MHz to 18 GHz.

**CONNECTOR:** SMA connector per MIL-STD-348 interface dimensions - mate nondestructively with MIL-C-39012 connector. Choice of male or female connector. When ordering, prefix model number with M for male and F for female.

**CONSTRUCTION:** Black, finned aluminum body, stainless steel connector; gold plated beryllium copper contacts.

**WEIGHT:** 14 g (0.49 oz)

**PHYSICAL DIMENSIONS:**

### Features

- /// **Miniature Size and Lightweight** - All models are approximately 1.6 inches long, and weigh less than 14 grams with male connector.
- /// **Quality Injection Molded Connector.**

### Specifications

**NOMINAL IMPEDANCE:** 50 Ω

**FREQUENCY RANGE:** dc to 18.0 GHz

#### MAXIMUM SWR:

Frequency (GHz)	SWR
dc - 8	1.20
8 - 12.4	1.30
12.4 - 18	1.35

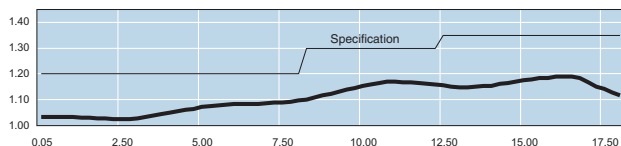

Typical M1419 SWR Performance

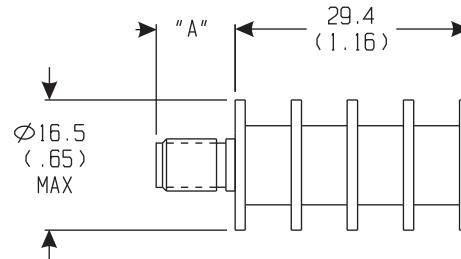

Model #	DIM A	Connector Type
M1419	11.2 (0.44)	SMA male
F1419	9.4 (0.37)	SMA female

**NOTE:** All dimensions are given in mm (inches) and are maximum, unless otherwise specified.