

Terminations & Loads

Models 1458 Medium Power, 3.5mm Connectors Conduction Cooled

dc to 22.0 GHz
 50 Watts



PHYSICAL DIMENSIONS:

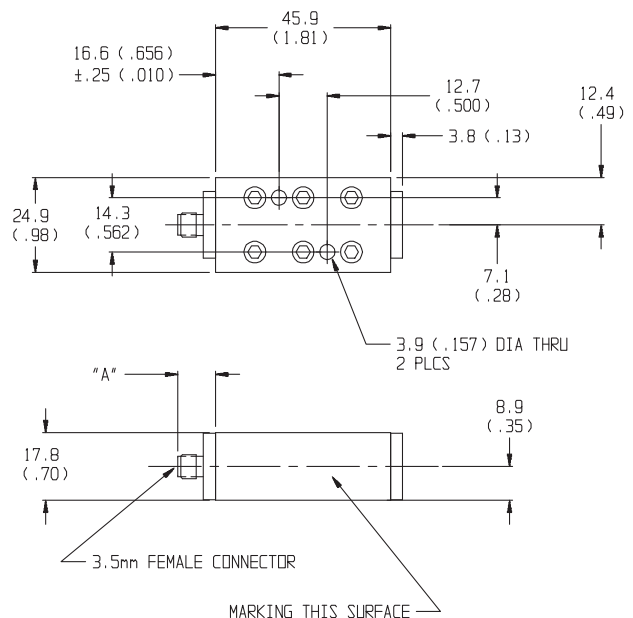

Model #	DIM A	Connector Type
1458-1	9.9±0.5 (0.35±0.02)	3.5mm female
1458-2	13.4±0.5 (0.53±0.02)	3.5mm male

Features

- /// **Compact Construction** - Lowest size/power ratio.
- /// **Rugged Construction** - Quality connector with special high temperature support bead.
- /// **Ideal for Space & Airborne Applications**

Specifications

NOMINAL IMPEDANCE: 50 Ω

FREQUENCY RANGE: dc to 22.0 GHz

MAXIMUM SWR:	
Frequency (GHz)	SWR
dc - 22.0	1.30

POWER RATING: 50 watts **average**, 1 kilowatts **peak** (5 μsec pulse width; 2.5% duty cycle) with case temperature held within **90°C maximum** with appropriate conductive heatsink.

TEMPERATURE RANGE: -55°C to 90°C case.

TEST DATA: Swept data plots of SWR from 50 MHz to 22 GHz is available at additional cost.

CONNECTOR: 3.5mm connectors - mate nondestructively with SMA per MIL-C-39012, 2.92mm, and other 3.5mm connectors. Choice of male (-2) or female connector (-1).

CONSTRUCTION: Aluminum alloy body, stainless steel connector; gold plated beryllium copper contacts.

WEIGHT: Net 56 g (1.9 oz) maximum

NOTE: All dimensions are given in mm (inches) and are nominal, unless otherwise specified.