

# 1N5819DP

## 1 A Surface Mount Schottky Barrier Diode

### PINNING

PIN	DESCRIPTION
1	Cathode
2	Anode

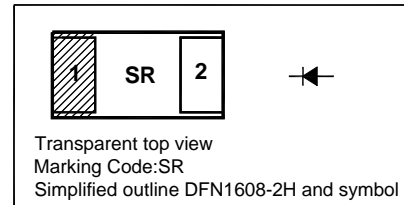

### Absolute Maximum Ratings ( $T_a = 25^\circ\text{C}$ )

Parameter	Symbol	Value	Unit
Reverse Voltage	$V_R$	40	V
Average Forward Rectified Current	$I_{F(AV)}$	1	A
Non-Repetitive Peak Forward Surge Current (8.3 ms Single Half Sine-Wave)	$I_{FSM}$	9	A
Power Dissipation	$P_{tot}$	450	mW
Operating Temperature Range	$T_j$	- 55 to + 125	$^\circ\text{C}$
Storage Temperature Range	$T_{stg}$	- 55 to + 125	$^\circ\text{C}$

### Characteristics at $T_a = 25^\circ\text{C}$

Parameter	Symbol	Min.	Max.	Unit
Reverse Breakdown Voltage at $I_R = 1 \text{ mA}$	$V_{(BR)R}$	40	-	V
Forward Voltage at $I_F = 0.1 \text{ A}$ at $I_F = 1 \text{ A}$ at $I_F = 3 \text{ A}$	$V_F$	- - -	0.45 0.6 0.9	V
Reverse Current at $V_R = 40 \text{ V}$ at $V_R = 4 \text{ V}$ at $V_R = 6 \text{ V}$	$I_R$	- - -	1 0.05 0.075	mA
Total Capacitance at $V_R = 4 \text{ V}$ , $f = 1 \text{ MHz}$	$C_{tot}$	-	120	pF

**TOP DYNAMIC**

# 1N5819DP

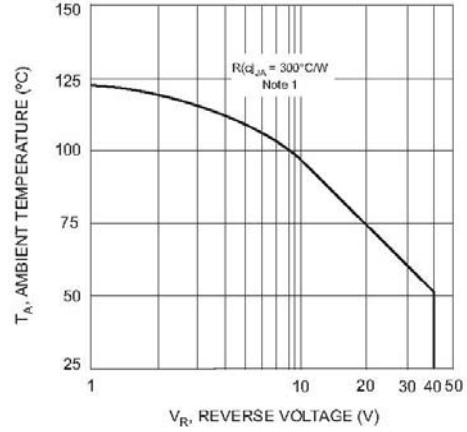
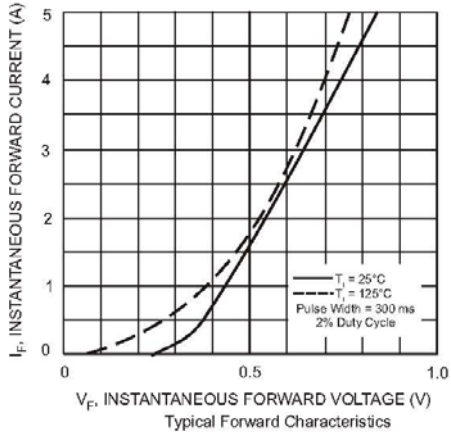

Typical Safe Operating Area

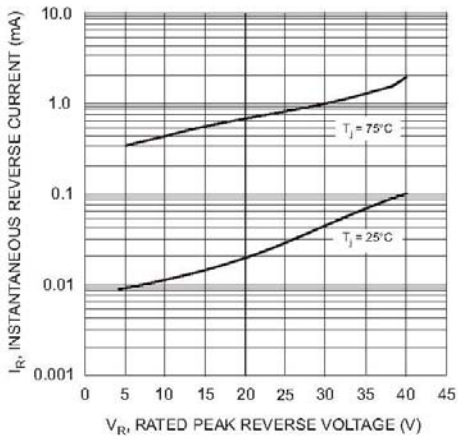

Typical Reverse Characteristic

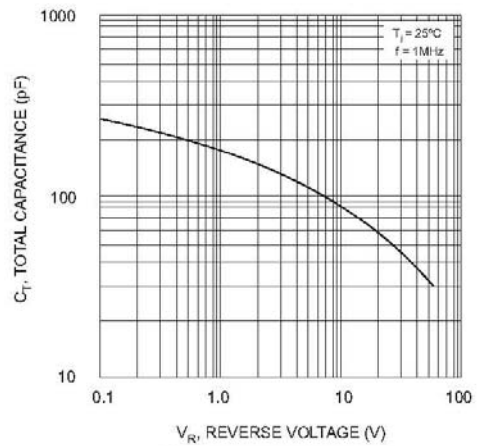

Typical Total Capacitance

**TOP DYNAMIC**

# 1N5819DP

## PACKAGE OUTLINE

Plastic surface mounted package; 2 leads

DFN1608-2H

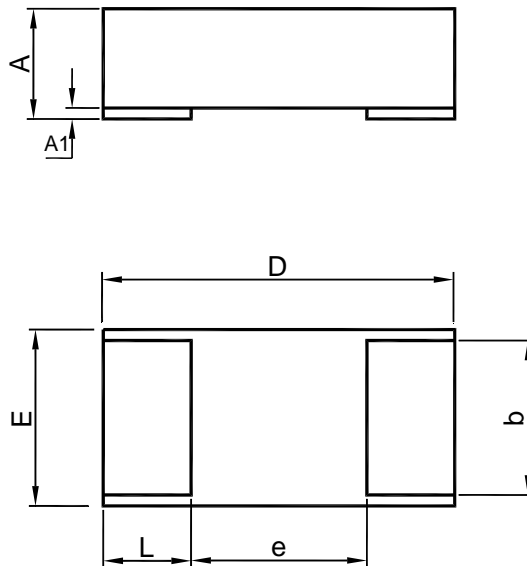

UNIT	A	A1	b	D	E	e	L
mm	0.55 0.45	0.05 0	0.75 0.65	1.65 1.55	0.85 0.75	0.85 0.75	0.45 0.35

## RECOMMENDED SOLDERING FOOTPRINT

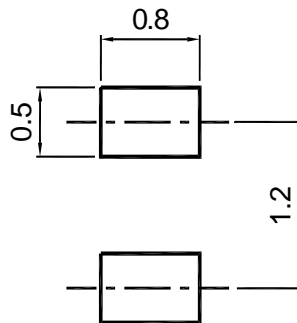

## Packing information

Package	Tape Width (mm)	Pitch		Reel Size		Per Reel Packing Quantity
		mm	inch	mm	inch	
DFN1608	8	4 ± 0.1	0.157 ± 0.004	178	7	4,000

**TOP DYNAMIC**