

SPECIFICATIONS

CIRCUIT: SPST

FUNCTION: MOMENTARY

CONTACT RATING: 1~50mA @ 5V~24VDC (resistive load)

OPERATING FORCE: Standard Force: 170 ± 40gf
High Force : 260 ± 50gf

TOTAL TRAVEL: 0.25 +0.2/-0.1mm

ELECTRICAL LIFE:

170gf (standard force): 500,000 operations min.

260gf (high force) : 300,000 operations min.

CONTACT RESISTANCE: 100 mΩ max. (initialvalue)

INSULATION RESISTANCE: 100 MΩ min.

DIELECTRIC STRENGTH: 500 RMS @ sea level.

OPERATING TEMPERATURE: -25°C to 70°C.

MATERIALS

CASE: PBT(UL94V-0).

HOUSING: PBT(UL94V-0).

ACTUATOR: PC

TERMINAL/CONTACT: Brass,silver plated.



HOW TO ORDER

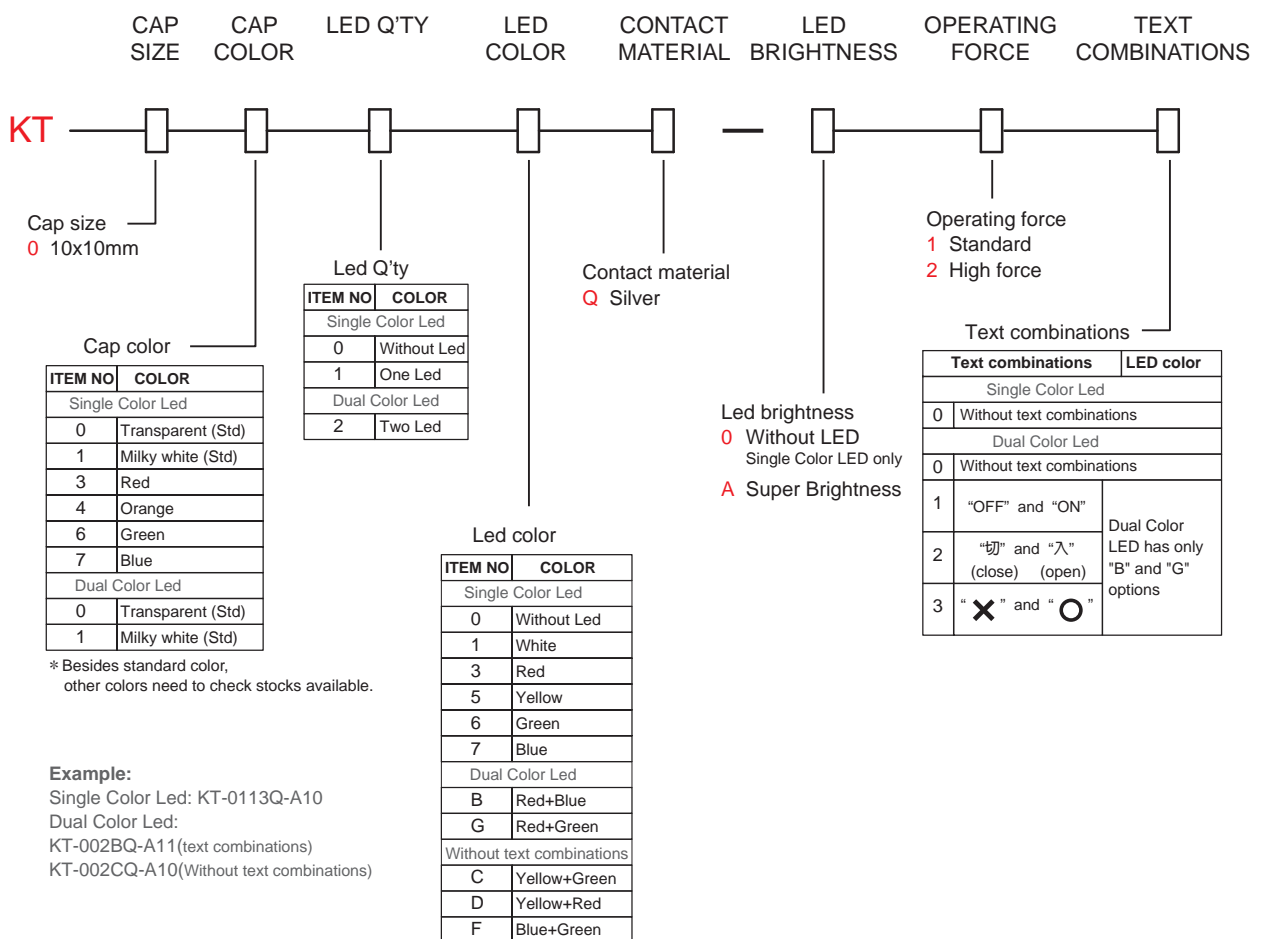

KT Series

Tact Switches

P.C.B MOUNTING / CIRCUIT

P.C.B MOUNTING

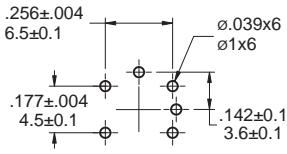

Single Color Led
TOP VIEW

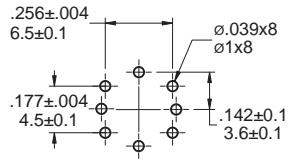

Dua Color Led
TOP VIEW

CIRCUIT

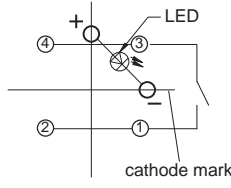

Single Color Led
TOP VIEW

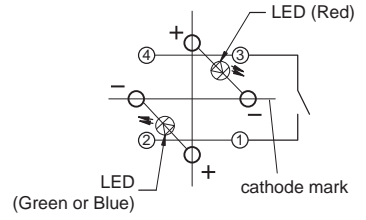

Dua Color Led
TOP VIEW

DIMENSION



Part No. Shown: KT-011 □ Q-A10

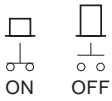
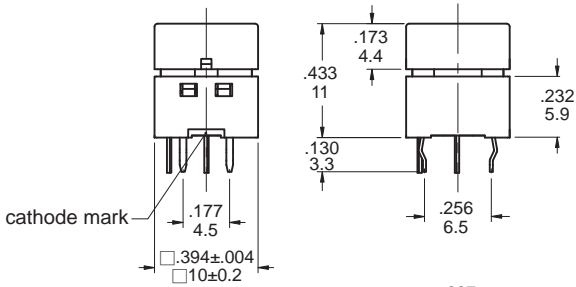
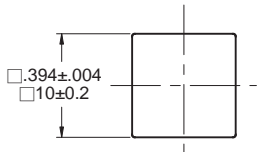

Switch Circuit Diagram

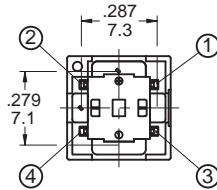

Part No. Shown: KT-002GQ-A13

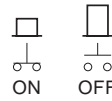
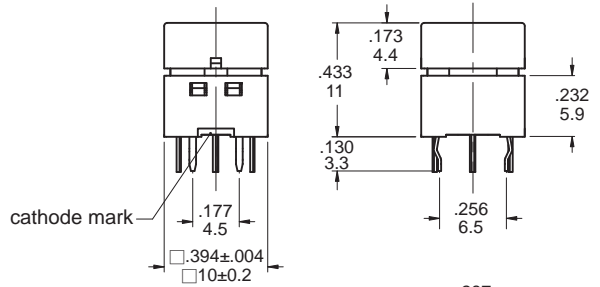
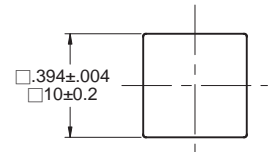

Switch Circuit Diagram

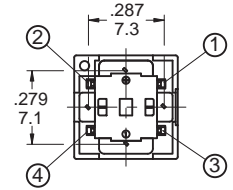

KT
Keyswitches