

SPECIFICATIONS

CONTACT RATING: Dependent upon contact material See Page 120.

MECHANICAL LIFE: 50,000 make-and-break cycles.

CONTACT RESISTANCE: 20 mΩ max. initial @ 2-4VDC
100mA for both silver and gold plated contacts.

INSULATION RESISTANCE: 1,000 MΩ min.

DIELECTRIC STRENGTH: 1,000 Vrms min.@sea level.

OPERATING TEMPERATURE: -30°C to 85°C.

MATERIALS

CASE: Diallyl phthalate(DAP) (UL94V-0).

PLUNGER: Nylon 6/6,black.

BUSHING: Brass or zinc,nickel plated.

HOUSING: Stainless Steel.

SWITCH SUPPORT: Brass.tin plated.

CONTACT/TERMINAL: Copper alloy or Brass, with silver or gold plated.(See Page 120)



HOW TO ORDER

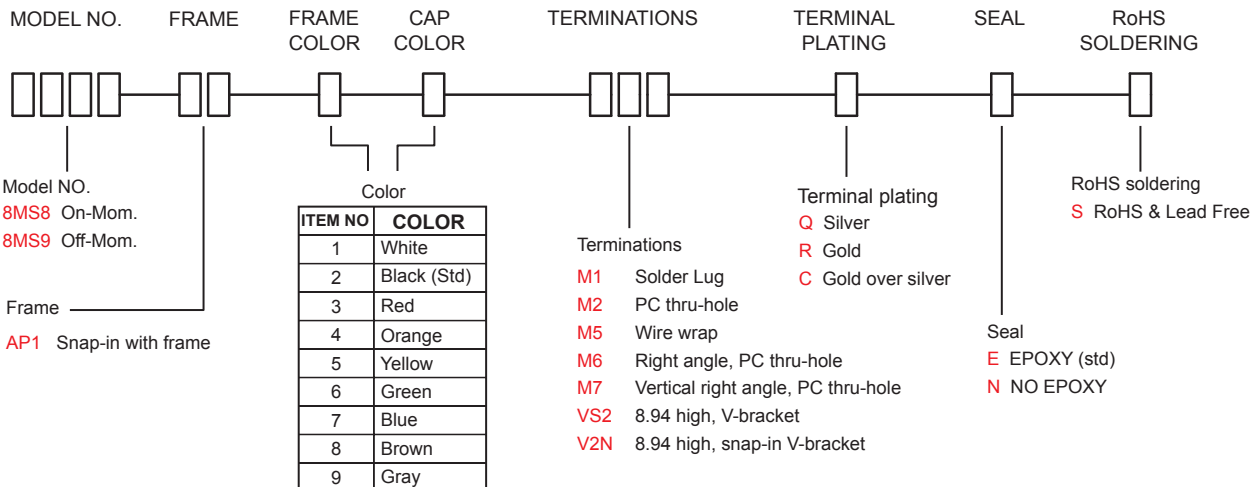
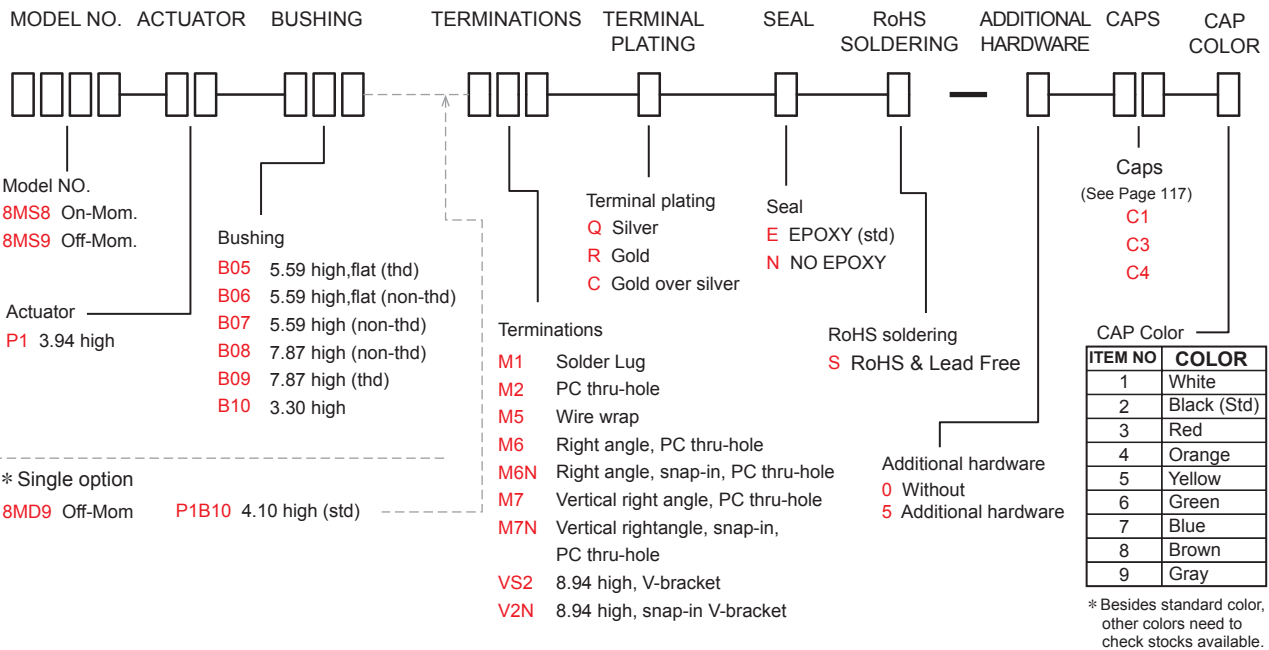

8M Series

Sub-Miniature Pushbutton Switches

SWITCH FUNCTION

NO. POLES	UL/CSA MODEL NO.	MODEL NO.	SWITCH FUNCTION		CONNECTED TERMINALS / SCHEMATIC	
			POS.1	POS.2	POS.1	POS.2
SP	Q2818	8MS8	ON	MOM	2-1 NC 1 • 2 (COMM) • 3 NO	2-3 NC 1 • 2 (COMM) • 3 NO
	Q2819	8MS9	OFF	MOM	OPEN	1-3 1 1 3
DP	Q2829	8MD9	OFF	MOM	OPEN	1-3,4-6 1 1 3 4 1 6

MOM=MOMENTARY



POLE OPTIONS

8M Pushbutton Switches

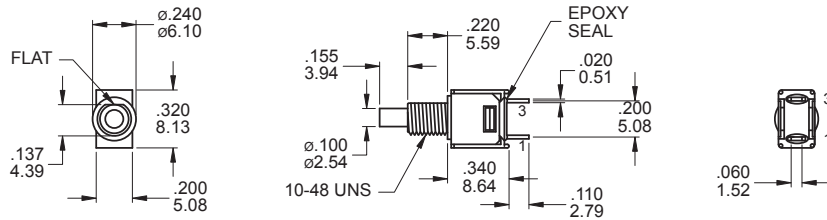

SPST

Part No. Shown : 8MS9P1B05M1QE

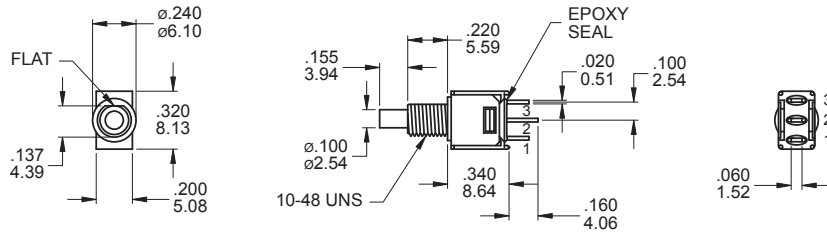

SPDT

Part No. Shown : 8MS8P1B05M1QE

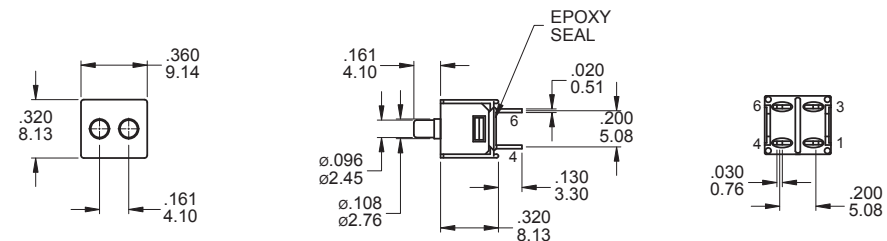
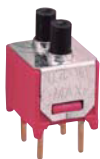

DPST

Part No. Shown : 8MD9P1B10M2RE

BUSHING OPTIONS

B05 THD

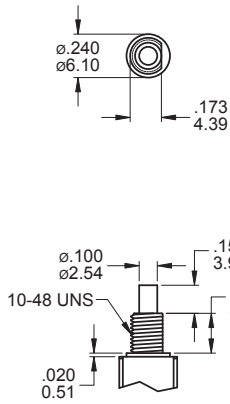

B06 NON-THD

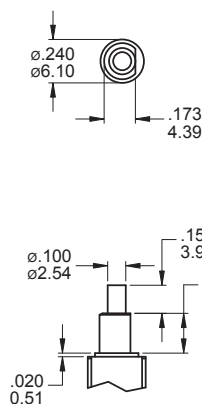

B07 NON-THD

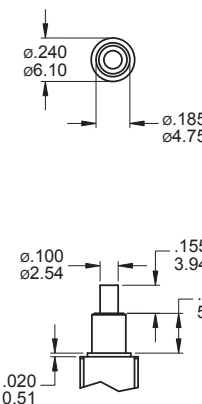

**B08 NON-THD
B09 THD**

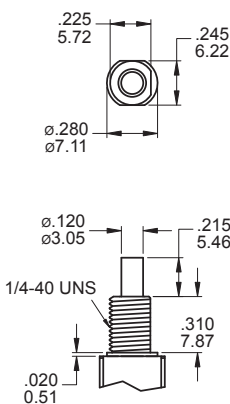

B10

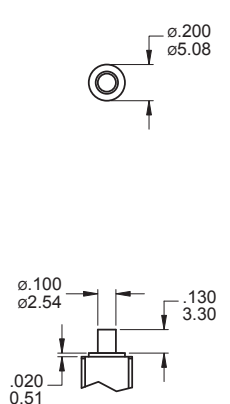

TERMINATION OPTIONS

M1 Solder lug

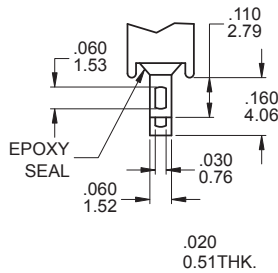

M2 PC Thru-hole

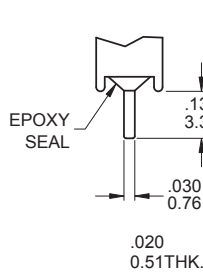

M5 Wire Wrap

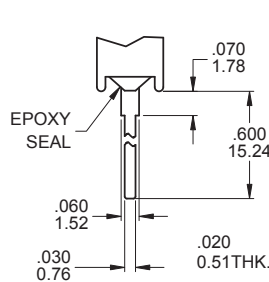

OTHER TERMINATION OPTIONS

- M6** Right angle P.C. Mount
- M6N** Right angle P.C. Mount with snap-in bracket
- M7** Right angle P.C. Mount
- M7N** Right angle P.C. Mount with snap-in bracket
- VS2** Right angle P.C. Mount
- V2N** Vertical bracket P.C. Mount with snap-in bracket

M6

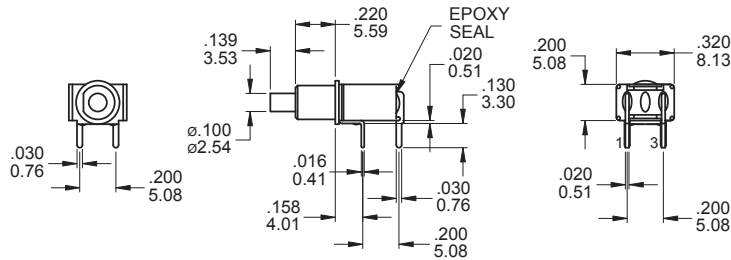

P.C. MOUNTING

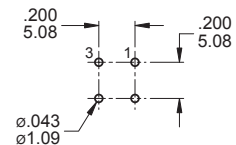

SPST

Part No. Shown : 8MS9P1B06M6RE

M6

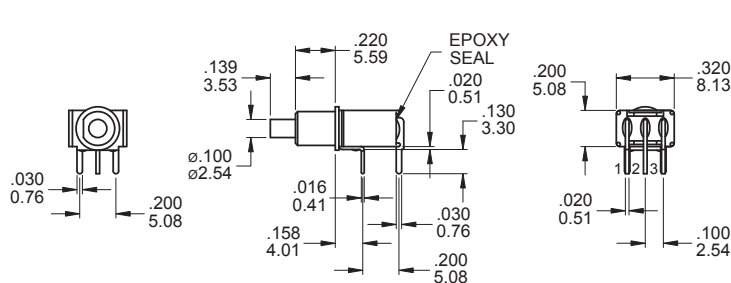

P.C. MOUNTING

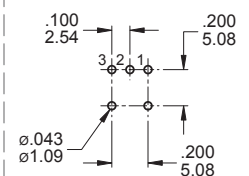

SPDT

Part No. Shown : 8MS8P1B06M6QE



8M Series

Sub-Miniature Pushbutton Switches

M6

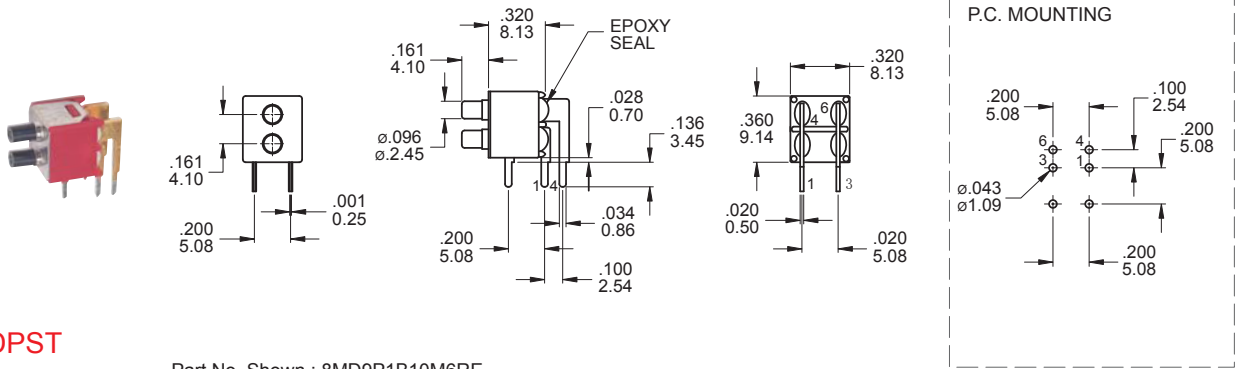

Part No. Shown : 8MD9P1B10M6RE

DPST

M7

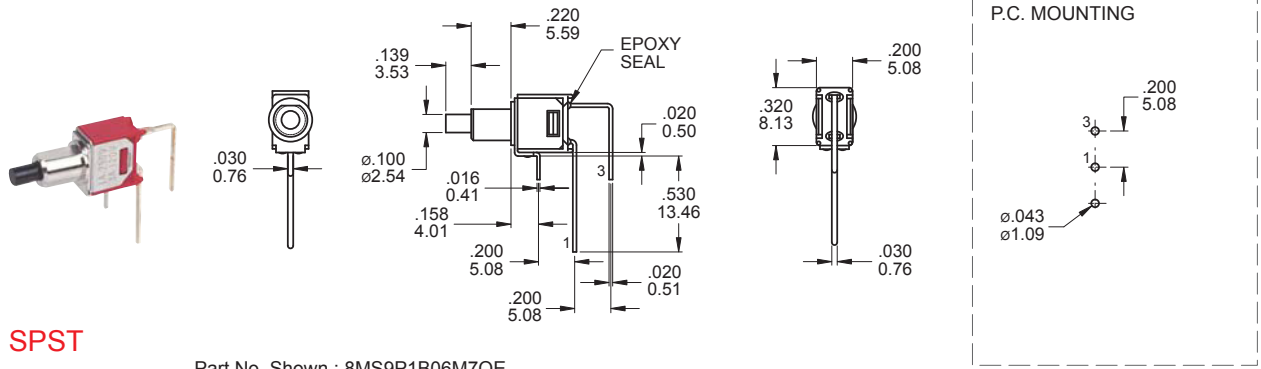

Part No. Shown : 8MS9P1B06M7QE

SPST

M7

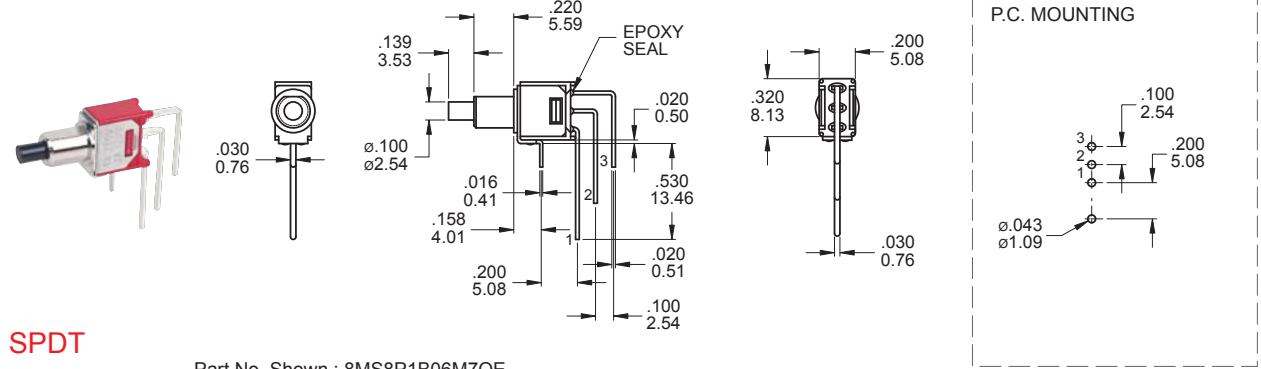

Part No. Shown : 8MS8P1B06M7QE

SPDT

VS2

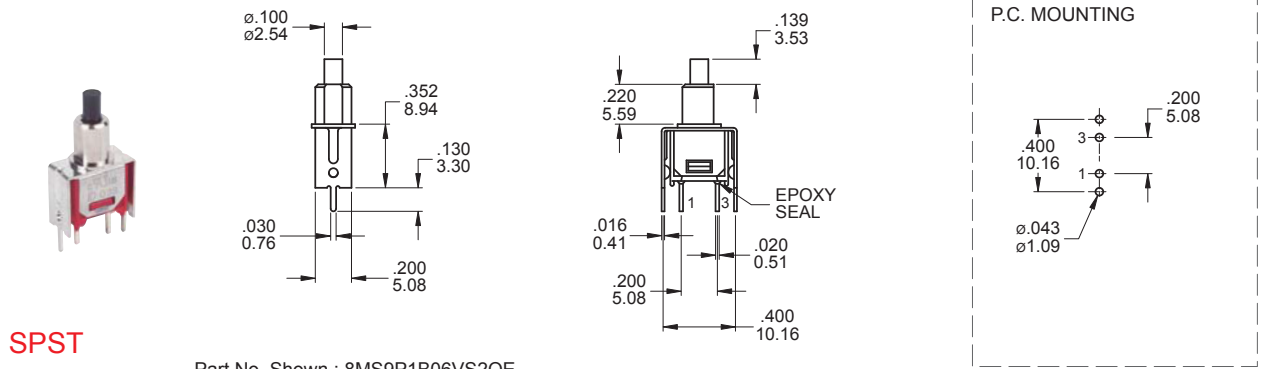

Part No. Shown : 8MS9P1B06VS2QE

SPST



8M Pushbutton Switches

VS2

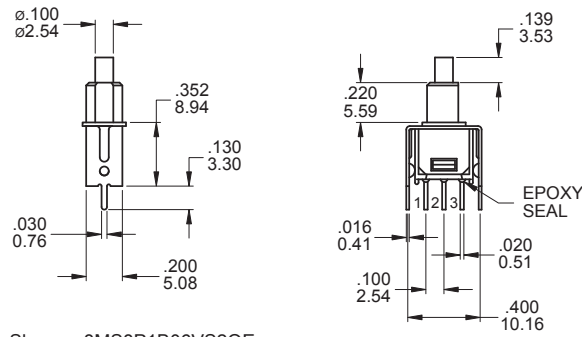

P.C. MOUNTING

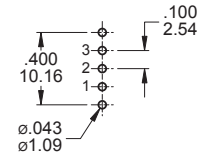

SPDT

Part No. Shown : 8MS8P1B06VS2QE

AP1

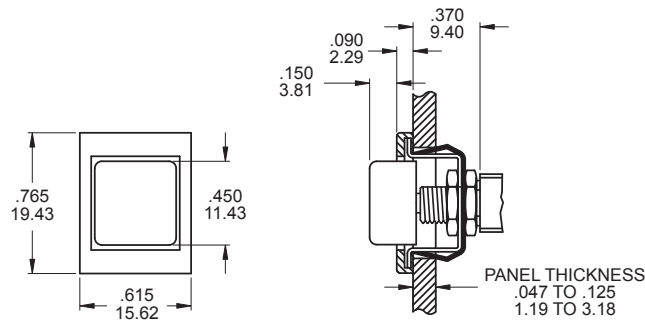

PANEL MOUNTING

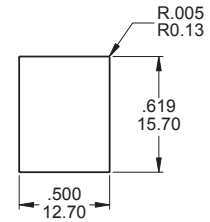

SPST

Part No. Shown : 8MS9AP122M1QE

SNAP-IN TERMINATION OPTIONS

M6N

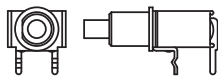

M7N

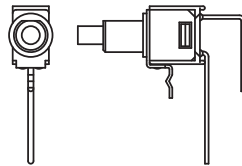

V2N

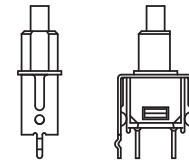

CAP OPTIONS

C1 For 8M Series ONLY

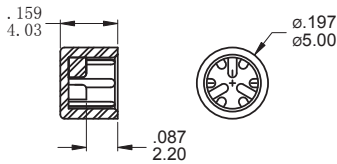

C2 For 8A,8B Series ONLY

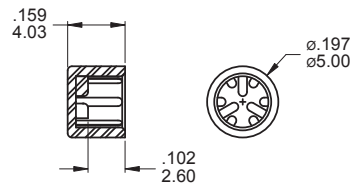

C3 For 8M Series B8,B9 Bushing ONLY

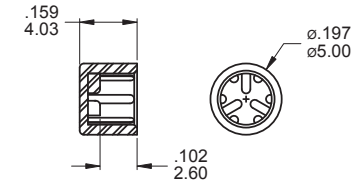

C4 For 8M Series ONLY

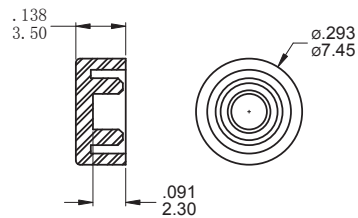

C5 For 8A,8B Series ONLY

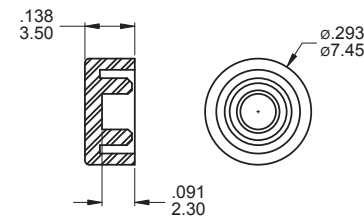

Cap Standard Color : White, Black, Red, Green

