

MICRO SWITCH MS3 SERIES

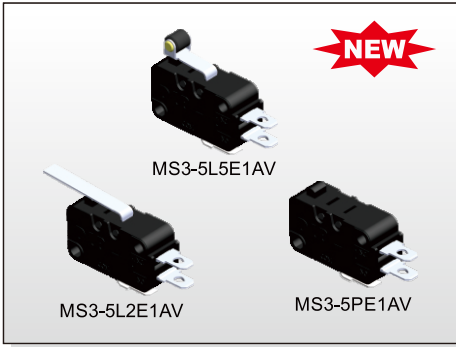

FEATURES

- ※27.8x10.3x15.9mm
- ※Solder Terminal & Quick-Connect Terminal

APPLICATION

- ※Notebook
- ※Audio equipment
- ※White goods

SPECIFICATION

Contact Rating	5A at 250V AC
Mechanical Durability	5,000,000 cycles (60 Operations/min)
Electrical Durability	100,000 cycles (30 Operations/min)
Contact Resistance	100mΩ max.
Insulation Resistance	100MΩ min. (at 500V VDC)
Dielectric Strength	Between terminals of the same polarity: 600 V AC(50Hz or 60Hz) shall be applied across terminals for 1 minute
	Between each terminal and ground: 1500 V AC(50Hz or 60Hz) shall be applied across terminals for 1 minute
Operating Frequency	Machanical: 120 operations/min max.
	Electrical: 20 operations/min max.
Operating Temp.	-40°C ~ +85°C

HOW TO ORDER

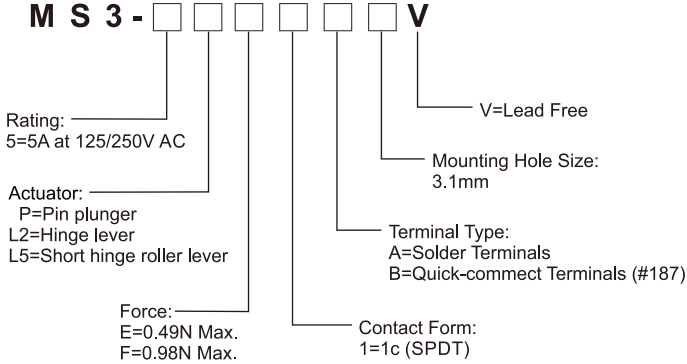

CIRCUIT

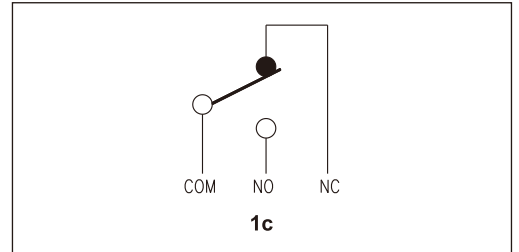

MS3-5PE1A

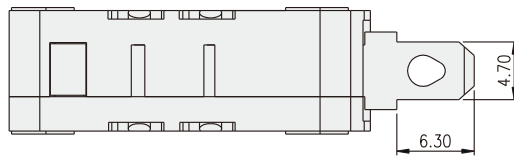

OPERATING CHARACTERISTICS

ITEM	SPEC.
OPERATING FORCE	0.49N MAX.
RELEASE FORCE	0.05N MIN.
OVERTRAVEL	1.0mm MIN.
MOVEMENT DIFFERENTIAL	0.40mm MAX.
OPERATING POSITION	14.70±0.40mm
PRETRAVEL	1.20mm MAX.

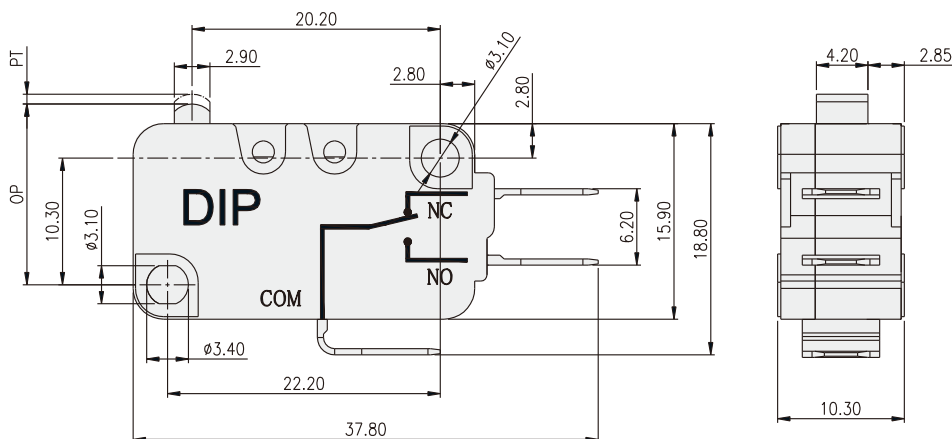

MICRO SWITCH
MS3 SERIES



MS3-5L2E1A

OPERATING CHARACTERISTICS

ITEM	SPEC.
OPERATING FORCE	0.29N MAX.
OVERTRAVEL	1.6mm MIN.
MOVEMENT DIFFERENTIAL	0.80mm MAX.
OPERATING POSITION	15.20±1.20mm
PRETRAVEL	4.0mm MAX.

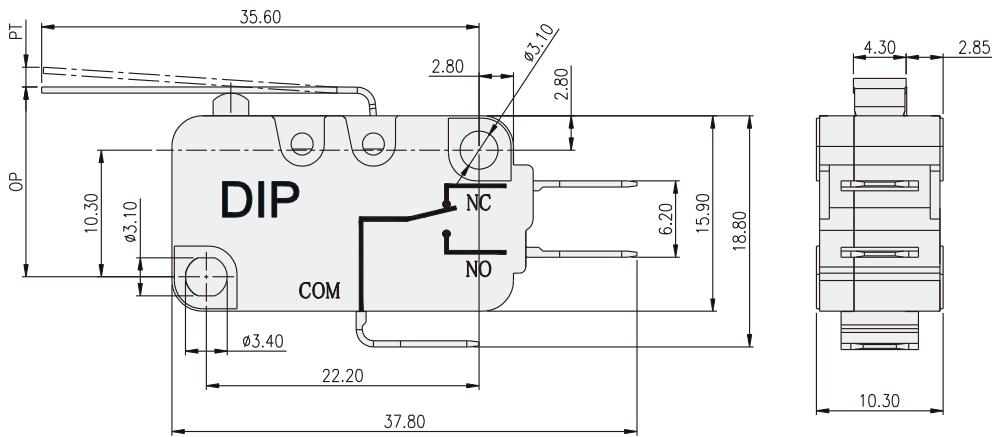
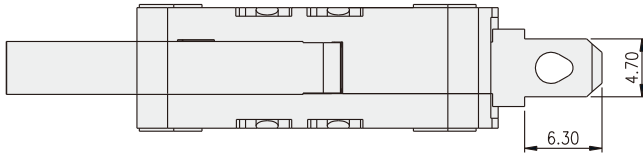

MS3-5L5E1A

OPERATING CHARACTERISTICS

ITEM	SPEC.
OPERATING FORCE	0.59N MAX.
RELEASE FORCE	0.04N MIN.
OVERTRAVEL	0.80mm MIN.
MOVEMENT DIFFERENTIAL	0.50mm MAX.
OPERATING POSITION	20.70±0.60mm
PRETRAVEL	1.60mm MAX.

