

25A Glass Passivated Single-Phase Bridge Rectifier

Voltage - 1200 to 1600 V

Forward Current –25A

FEATURES

- ◆ Glass passivated chip
- ◆ Low Reverse Leakage Current
- ◆ High surge current capability
- ◆ Case to Terminal Isolation Voltage 2500V

MECHANICAL DATA

- ◆ Case: plastic package
- ◆ Marking / Polarity: Marked on Body
- ◆ Weight: About 6.9 grams

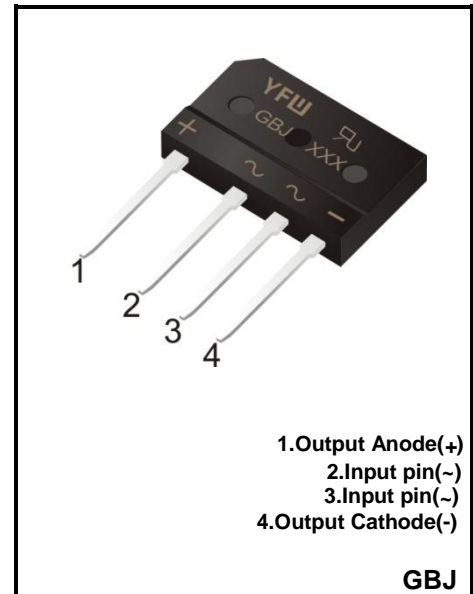

Maximum Ratings and Thermal Characteristics @ Ta = 25°C unless otherwise noted

Parameter	Symbols	GBJ2512	GBJ2514	GBJ2516	Units
Maximum Recurrent Peak Reverse Voltage	V_{RRM}	1200	1400	1600	V
Average Forward Output Rectified Current@Ta =85°C	I_F (AV)	25			A
Forward Voltage Per Leg @ $I_{FM} = 25A$	V_F	1.1			V
Peak Forward Surge Current 8.3ms Single Half Sine-wave superimposed on rated load	I_{FSM}	350			A
Maximum DC reverse current at rated DC blocking voltage per leg	I_R	5 500			μA
Rating for fusing (t<8.3ms)	i^2t	500			A ² S
Rms isolation voltage from case to leads	V_{isol}	2500			V
Maximum thermal resistance per leg	$R_{\theta JC}$	1.0			°C/W
Operating Junction and storage temperature range	T_J, T_{STG}	-55~150			°C

Note:

- 1.Junction to case with heatsink
- 2.Recommended mounting position is to bolt down on heatsink with silicone thermal compound for maximum heat transfer with M3 screw

Characteristics(Typical)

Fig 1-forwardCurrent derating Curve

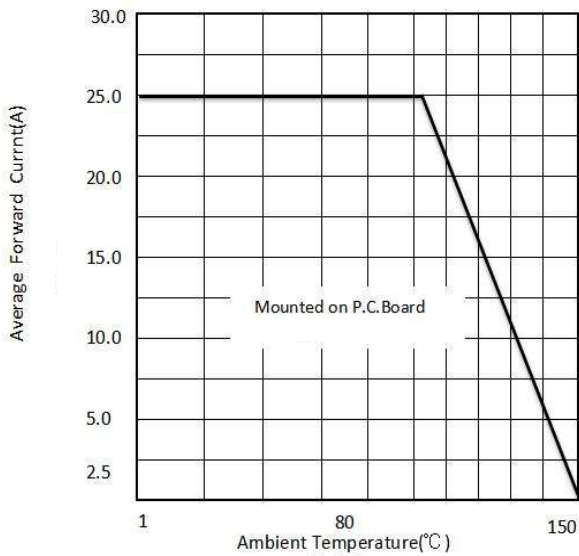

Fig.2-Maximum Non-Repetitive Surge Current

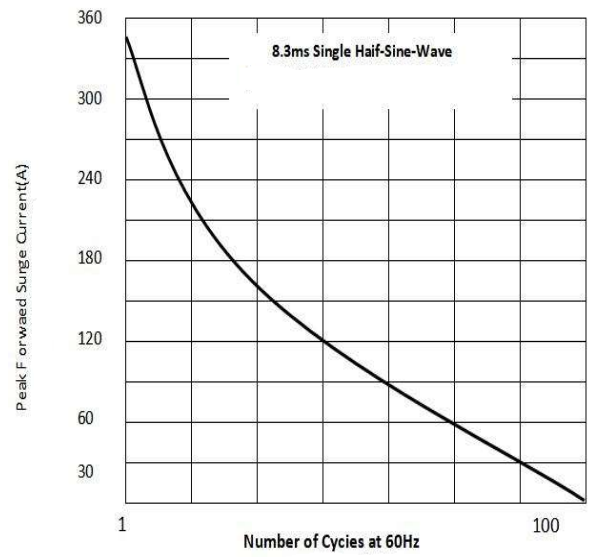

Fig.3-Typical Reverse Characteristics

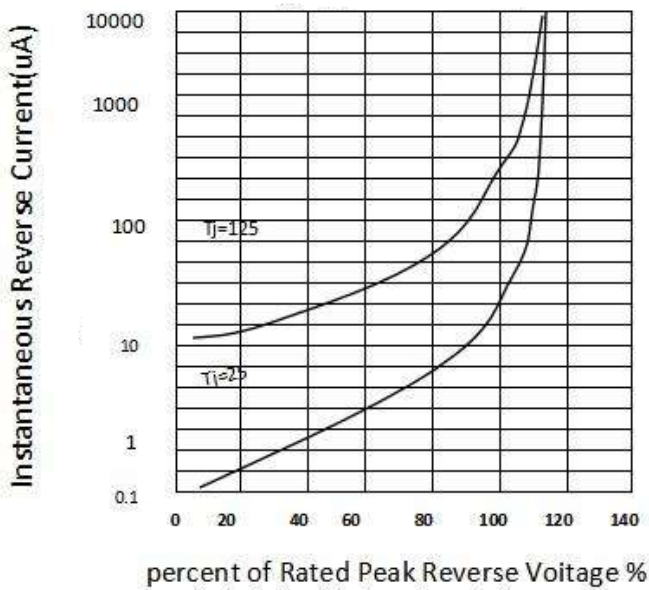
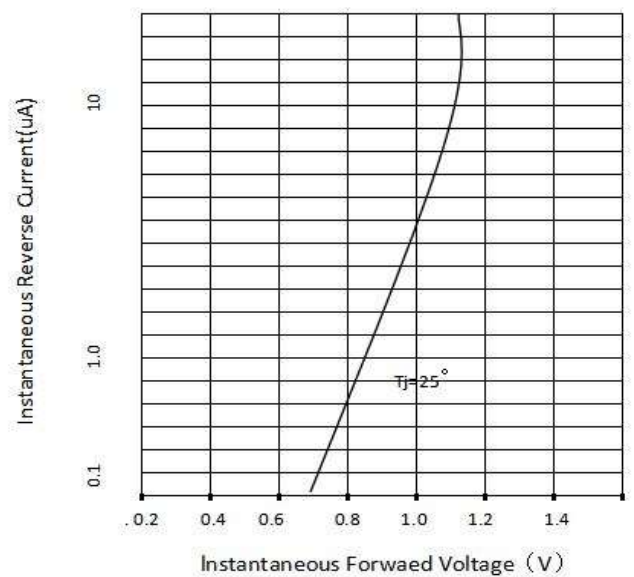
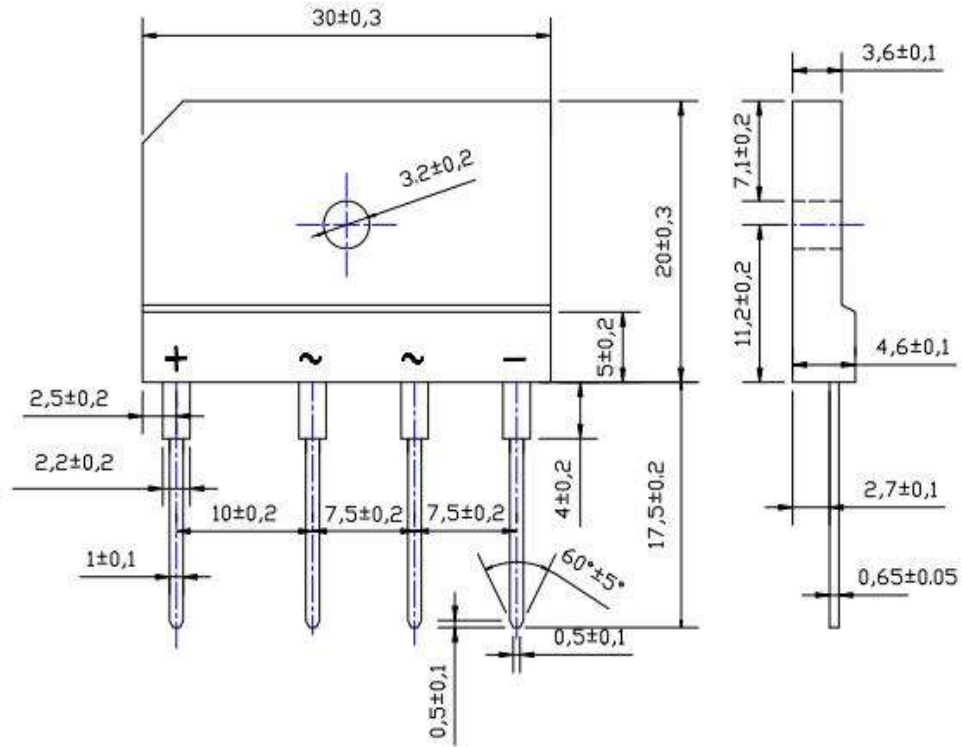

Fig.4-Typical Forward Characteristics



Package Outline

GBJ



Summary of Packing Options

Package	Packing Description	Packing Quantity	Industry Standard
GBJ	BOX	200	EIA-481-1