

DO NOT SCALE FROM THIS PRINT

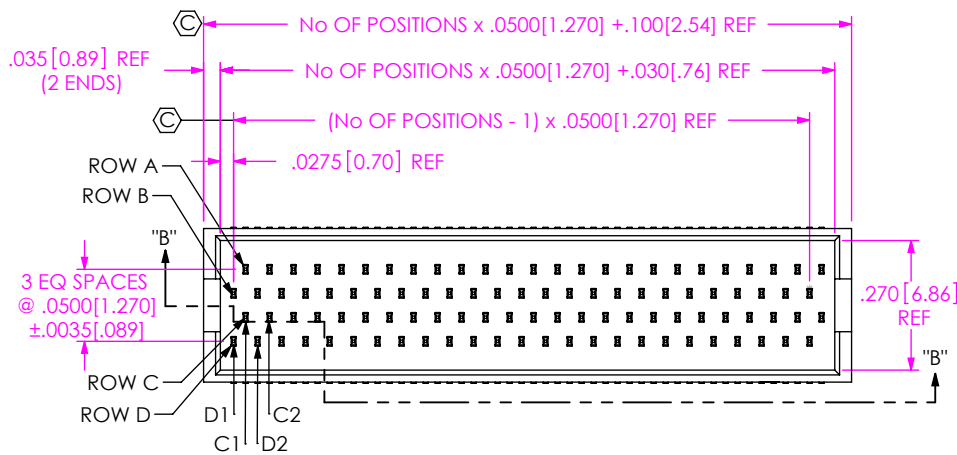

FOUR ROWS WTOLC- 4x XX H XX XXX Q XX XX XX

No OF POSITIONS
05, 10, 15, 20, 25
30, 35, 40, 45, 50
(PER ROW)

HIGH

LEAD STYLE
(SEE TABLE 1)
02, 12, 22, 32

PLATING SPEC
(VALUES GIVEN ARE IN MICRO-INCHES)
S: SELECTIVE, 30 Au / 50 Ni MIN ON CONTACT, 3 Au / 50 Ni MIN ON TAIL
L: LIGHT SELECTIVE, 10 Au / 50 Ni MIN ON CONTACT, 3 Au / 50 Ni MIN ON TAIL
F: FLASH GOLD, 3 Au / 50 Ni MIN ON CONTACT, 3 Au / 50 Ni MIN ON TAIL
STL: SELECTIVE, 30 Au / 100 Ni MIN ON CONTACT, 100-250 Sn-Pb / 50 Ni MIN ON TAIL (SEE NOTE 6)

ROW SPEC
Q: QUAD

PACKAGING
BLANK: TUBE (SEE NOTE 2)
TR: TAPE & REEL (SEE NOTE 7 & 8)

PICK & PLACE OPTION
P: PICK & PLACE PAD (EXISTING CUSTOMER SUPPORT ONLY)
K: POLYIMIDE FILM PAD (USE K-DOT-.354-.469-.005)

OPTIONS
LC: LOCKING CLIP (SEE NOTE 5) (USE LC-09-TM) (NOT AVAILABLE WITH -A)
A: ALIGNMENT PIN (USE WTOLC XX Q A FOR STYLE 02 AND WTOLCH XX Q A FOR STYLES 12, 22 & 32) (NOT AVAILABLE WITH LC)

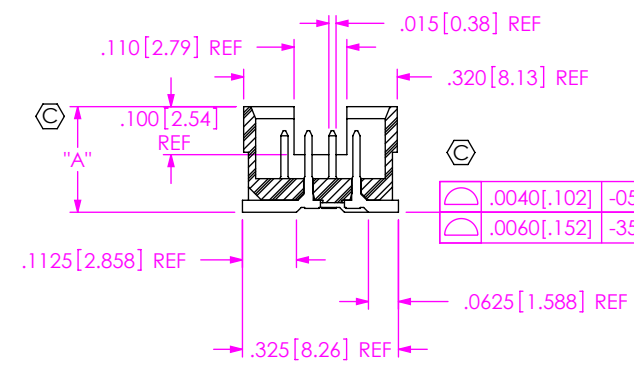
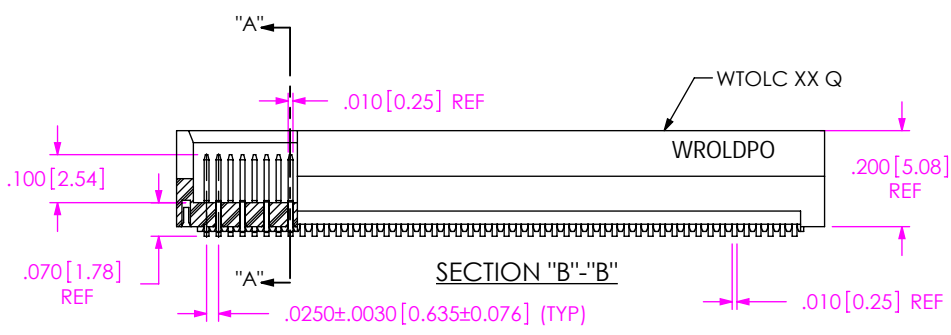

	.0040[.102]	-05 THRU -30 POS
	.0060[.152]	-35 THRU -50 POS

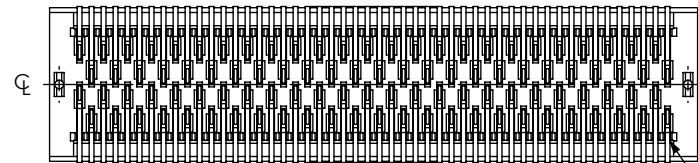

FIG 1

T 1M13 01 XXX 2 (SEE NOTE 6)

LEAD STYLE	"A"	USE TERMINAL	SEE FIG	BOARD SPACE WHEN MATED WITH SOLC
02	.2200[5.588]	T-1M13-01-XXX-2	1	.2500[6.350]
12	.2850[7.239]	T-1M14-02-XXX-2	2	.3150[8.000]
22	.3637[9.238]	T-1M14-03-XXX-2	2	.3937[10.000]
32	.4424[11.237]	T-1M14-04-XXX-2	2	.4724[12.000]

- NOTES:
1. MINIMUM PUSHOUT FORCE: 6 OZ.
 2. PARTS TO BE PACKAGED IN TUBES.
 3. S PLATING CAN BE SUBSTITUTED FOR L AND F PLATING STYLES.
 4. © REPRESENTS A CRITICAL DIMENSION.
 5. DUE TO THE HIGH AMOUNT OF INSERTION FORCE NEEDED, THE LC OPTION IS NOT COMPATIBLE WITH AUTO PLACEMENT. WORLDPO RECOMMENDS MANUAL PLACEMENT FOR ALL ASSEMBLIES WITH THE LC OPTION.
 6. FOR -STL PLATING:
USE SUB T 1M13 01 STL 2 FOR 02 LEAD STYLE.
USE T 1M14 0X STL 2 FOR 12, 22, 32 LEAD STYLES.
 7. ORDERS WILL BE PACKAGED ACCORDING TO THE WORLDPO PACKAGING EFFICIENCY STANDARDS (SPES) FOUND ON WWW.WORLDPO.COM.
 8. ATTACH LABEL TO EACH REEL.

UNLESS OTHERWISE SPECIFIED, DIMENSIONS ARE IN INCHES. TOLERANCES ARE:
DECIMALS ANGLES
.XX: ±.01[0.3] ±5°
.XXX: ±.005[0.13]
.XXXX: ±.0020[0.051]

PROPRIETARY NOTE
THIS DOCUMENT CONTAINS CONFIDENTIAL AND PROPRIETARY INFORMATION AND ALL DESIGN, MANUFACTURING, REPRODUCTION, USE, PATENT RIGHTS AND SALES RIGHTS ARE EXPRESSLY RESERVED BY WORLDPO, INC. THIS DOCUMENT SHALL NOT BE DISCLOSED, IN WHOLE OR PART, TO ANY UNAUTHORIZED PERSON OR ENTITY NOR REPRODUCED, TRANSFERRED OR INCORPORATED IN ANY OTHER PROJECT IN ANY MANNER WITHOUT THE EXPRESS WRITTEN CONSENT OF WORLDPO.

MATERIAL: DO NOT SCALE DRAWING SHEET SCALE: 1:0.4
BODY: LCP UL 94 VO, COLOR: BLACK
TERMINAL:



Shenzhen WorldPO Precision Devices Co., LTD
TEL :+86 013316922511 GU@WORLDPO.COM

DESCRIPTION:
QUAD ROW STAGGERED SMT TERMINAL ASM

DWG. NO.
WTOLC- 4x XX H XX XXX Q XX XX XX

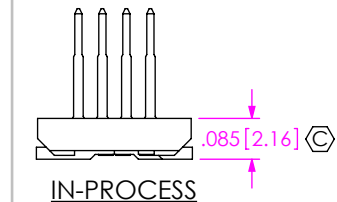
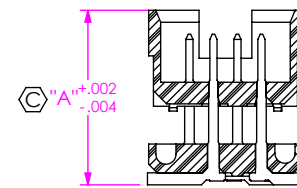
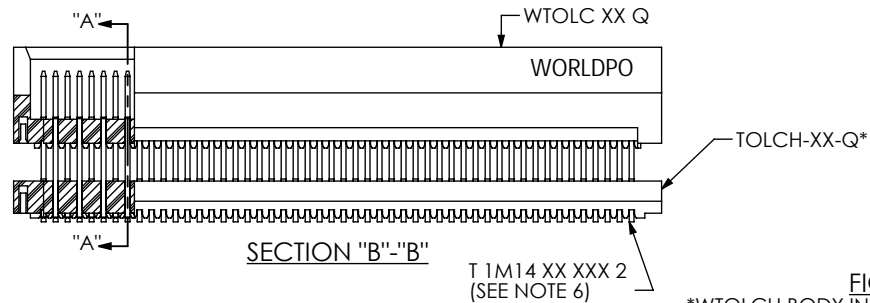
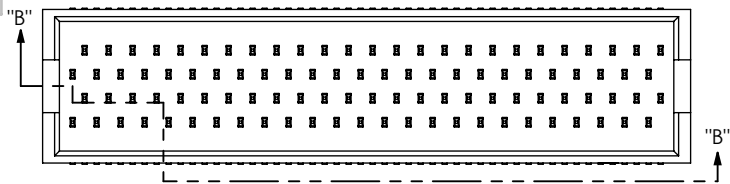

	.0040[.102]	05 THRU 30 POS
	.0060[.152]	35 THRU 50 POS

FIG 2
*WTOLCH BODY IN THIS DESIGN REFLECTS ALTERNATE STANDOFF DESIGN

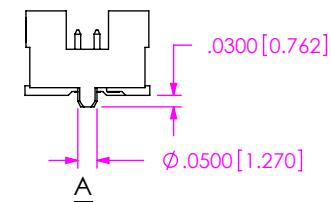
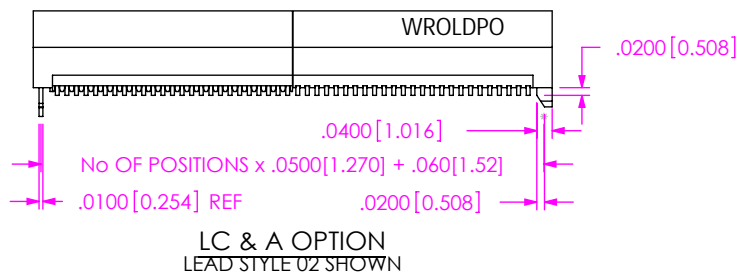
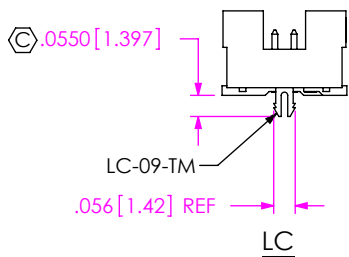
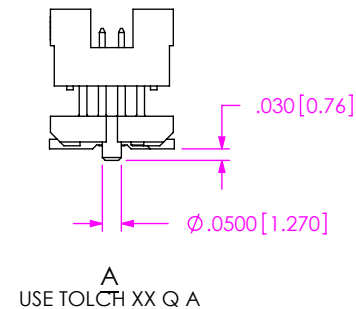
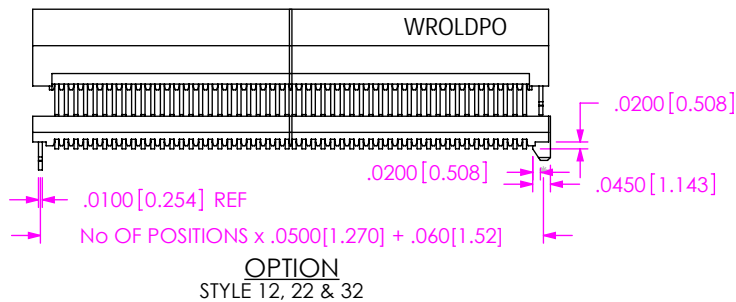
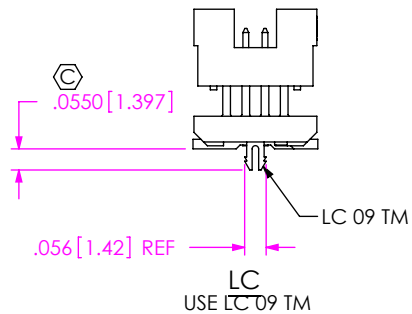

PROPRIETARY NOTE
THIS DOCUMENT CONTAINS CONFIDENTIAL AND PROPRIETARY INFORMATION AND ALL DESIGN, MANUFACTURING, REPRODUCTION, USE, PATENT RIGHTS AND SALES RIGHTS ARE EXPRESSLY RESERVED BY WORLDPO, INC. THIS DOCUMENT SHALL NOT BE DISCLOSED, IN WHOLE OR PART, TO ANY UNAUTHORIZED PERSON OR ENTITY NOR REPRODUCED, TRANSFERRED OR INCORPORATED IN ANY OTHER PROJECT IN ANY MANNER WITHOUT THE EXPRESS WRITTEN CONSENT OF WORLDPO.

WORLDPO

Shenzhen WorldPO Precision Devices Co., LTD
TEL :+86 013316922511 GU@WORLDPO.COM

SHEET SCALE: 1:0.4

DESCRIPTION:
QUAD ROW STAGGERED SMT TERMINAL ASM
DWG. NO.
WTOLC- 4x XX H XX XXX Q XX XX XX

BY: D PURVIS 03/10/2023 SHEET 2 OF 3

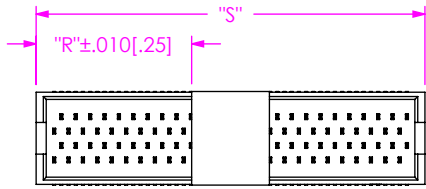

"S" = (# OF POS x .050[1.27]) + .100[2.54]
 "R" = (S/2) - .135[3.429]

ASP-90590-01-S

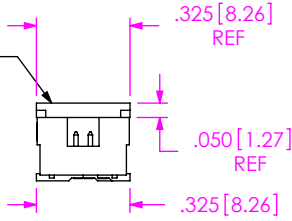

P & PL OPTION
 PICK & PLACE PAD

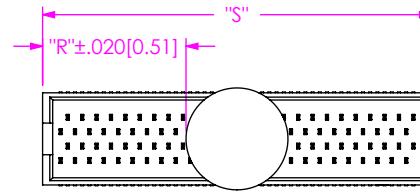

"S" = (# OF POS x .050[1.27]) + .100[2.54]
 "R" = (S/2) - (.354[9.00])/2

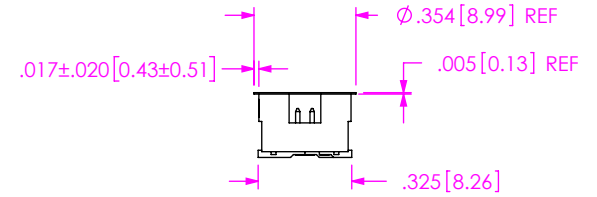

K OPTION
 PICK & PLACE PAD

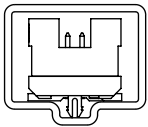

02/12 K/12 LC
 PT-1-24-02-70 TUBE
 TP-07 PLUG

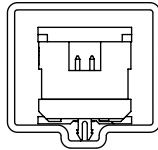

12 LC P/ 22/ 22 K/ 22 LC P
 PT-1-24-01-70 TUBE
 TP-29 PLUG

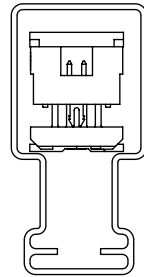

22 P/22 A P
 PT-1-24-01-44 TUBE
 TP-13 PLUG

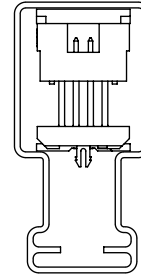

32
 PT-1-24-0T-44 TUBE
 TP-13 PLUG

PACKAGING VIEWS

PROPRIETARY NOTE

THIS DOCUMENT CONTAINS CONFIDENTIAL AND PROPRIETARY INFORMATION AND ALL DESIGN, MANUFACTURING, REPRODUCTION, USE, PATENT RIGHTS AND SALES RIGHTS ARE EXPRESSLY RESERVED BY WORLDPO, INC. THIS DOCUMENT SHALL NOT BE DISCLOSED, IN WHOLE OR PART, TO ANY UNAUTHORIZED PERSON OR ENTITY NOR REPRODUCED, TRANSFERRED OR INCORPORATED IN ANY OTHER PROJECT IN ANY MANNER WITHOUT THE EXPRESS WRITTEN CONSENT OF WORLDPO.

SHEET SCALE: 1:0.4

WORLDPO

Shenzhen WorldPO Precision Devices Co., LTD

TEL :+86 013316922511 GU@WORLDPO.COM

DESCRIPTION:
 QUAD ROW STAGGERED SMT TERMINAL ASM

DWG. NO.
 WTOLC- 4x XX H XX XXX Q XX XX XX

BY: D PURVIS 03/10/2023 SHEET 3 OF 3